



Welcome to the 2015 GCAGS/GCSSEPM Convention!!

Welcome

On behalf of the Houston Geological Society and the GCAGS convention team, I am excited to welcome you to the 2015 GCAGS/GCSSEPM Convention. We have put together a very worthy technical, educational, and social program to commemorate our 65th annual convention. There couldn't be a better site for this milestone, because Houston is the center of the global oil and gas business.

Our theme for this year's meeting is, "**Technology – Education – Leadership – Discovery.**" This theme is reflected in our technical and educational program of 180 talks and posters, five field trips, seven short courses, and three forums.

I hope that you are able to take advantage of the numerous offerings we have at this year's convention. While I cannot cover everything here, I do want to mention some of the convention highlights:

- The AAPG-SEG Student Expo will run concurrently with our event. This will allow future graduates the opportunity to discover the advantages of becoming involved in their local geological society and GCAGS when they enter the industry.
- Students will present their research posters in the exhibit hall. During the Presidents' Reception, we will recognize the 1st, 2nd, and 3rd place winners of the Best Student Poster award.
- Several social events, starting with Sunday's YP "Meet & Greet," the traditional Icebreaker, the Presidents' Reception, Monday evening at the St. Arnold Brewery, and a surprise for Tuesday afternoon during the break.
- An "Oldest GCAGS Bag Contest" will be held during the Presidents' Reception, so dig in your closet and find your oldest bag for a chance to win!
- Three excellent and topical lunches for today's exploration business climate.
- Three excellent forums on Tuesday on interesting and important topics.
- Programs for spouse and guest enrichment based out of the Spouse Room in the adjacent Hilton Hotel.
- "More! Rocks in Your Head," the popular one-day workshop for local earth science teachers. This workshop offers relevant material for them to take back to their classroom and encourage the next generation of geologists.



I ask you to visit the vendors in the exhibit hall. Their valued presence here informs us of their services and provides financial support to the GCAGS. We thank our sponsors (pages 18–19), without whom an excellent conference such as ours would be impossible. Lastly, I would like to express my thanks to the many volunteers who have worked so hard to put this event together.

Thank you for attending, and I look forward to seeing you at one of the many events we have planned this week.

Sincerely,



Larry D. Bartell
2015 GCAGS General Chair



Tuesday Only!
8:00 am–3:00 pm

Looking for a place to store your luggage on the last day after checking out of your hotel? Bring your items to Room 350A on Level 3 of the George R. Brown Convention Center on Tuesday morning beginning at 8:00 am. We'll look after them for you while you attend sessions, posters, and the exhibition.



Like us on Facebook at <https://www.facebook.com/GCAGS>



Follow us on Twitter at <https://twitter.com/GCAGSorg> or via username @GCAGSorg (Use #GCAGS, #GCAGS2015, or #GCAGSHouston in all your conference posts!)



You can also find us on LinkedIn in the group named "Gulf Coast Association of Geological Societies (GCAGS)"



Scan QR code at left
to access the
2015 Convention App



4 2015 GCAGS/GCSSEPM 65th Annual Convention & Exhibition

All activities will take place on Level 3 of the George R. Brown Convention Center or the Hilton Americas (connected to the Convention Center by skybridge) unless otherwise specified. All times and locations are subject to change. Please visit www.gcagshouston.com or your mobile app for continually updated information.

Thursday, September 17, 2015

3:00 pm departure Field Trip #1, Upper Cambrian Microbial Carbonate Mounds in Central Texas, departure and return at Hilton, p. 42

Saturday, September 19, 2015

8:00 am departure Field Trip #5, Galveston and the Brazos Delta as Reservoir Analogs, departure and return at Hilton, p. 43

8:30 am departure Field Trip #3, Geology of Canyon Lake Gorge, departure and return at Hilton, p. 42

8:30 am–3:30 pm Teacher Workshop (More! Rocks In Your Head), Region 4 Dev. Center, The Woodlands, p. 46

9:00 am–3:30 pm Short Course #2, Gulf of Mexico Primer—Regional Overview of the U.S. Deepwater Gulf of Mexico, Hilton 336AB, p. 40

9:00 am–3:30 pm Short Course #3, Introduction to Regional and Play-Based Exploration, Hilton 337AB, p. 40

9:00 am–4:00 pm Short Course #4, Core Workshop: Woodbine Sand and Eagle Ford Shale, BEG Houston Center, p. 40

11:30 am–12:30 pm Short Course Participant Lunch, Hilton - Ballroom of the Americas E

3:00 pm–6:00 pm Registration Open, GRB CC Hall B3, p. 20

5:30 pm–7:00 pm GCAGS Continuity Committee Meeting (by invitation only), Hilton - 330, p. 17

Sunday, September 20, 2015

7:00 am–8:00 pm Registration, GRB CC Hall B3, p. 20

8:00 am departure Field Trip #6, Hands-On Geophysical Data Acquisition: Characterizing Shallow Gulf Coast Sediments Using Cuttings, Well Logs, and Seismic Surveys, departure and return at Hilton, p. 43

8:00 am departure Field Trip #7, Field Work on Active Faults in Houston, departure and return at Hilton, p. 43

8:00 am–2:00 pm GCAGS Board Meeting (by invitation only), Hilton 339AB, p. 17

8:00 am–4:00 pm Exhibitor Move-In, GRB Hall B3, p. 55–61

9:00 am–12:30 pm Short Course #8, Introduction to Reservoir Fluid PVT Analysis for Geologists, Hilton 335A, p. 41

9:00 am–3:30 pm Short Course #5, IBA Training Session (Students Only), Hilton 336AB, p. 41

9:00 am–3:30 pm Short Course #6, A User's Guide to Exploration and Production Biostratigraphy, Hilton 335C, p. 41

- 9:00 am–3:30 pm Short Course #7, Handheld X-Ray Fluorescence (XRF) Chemostratigraphy: Theory and Application to Mudrock Drill Core and Cuttings, Hilton 337AB, p. 41
- 11:30 am–1:30 pm Short Course Participant Lunch, Hilton Ballroom of the Americas E
- 1:00 pm–5:00 pm Speakers'/Judges' Room, GRB CC 330AB, p. 21
- 3:30 pm–5:00 pm Young Professionals' and Students' 'Meet & Greet', GRB CC Grand Ballroom Pre-Function Area, p. 45
- 5:00 pm–6:00 pm Opening Session/Awards Ceremony, GRB CC 310ABC, p. 22
- 6:00 pm–8:00 pm Icebreaker in Exhibit Hall with Poster Session, GRB CC Hall B3, p. 8

Monday, September 21, 2015

- 7:00 am–8:00 am Speakers' and Poster Presenters' Breakfast, GRB CC Grand Ballroom B, p. 20
- 7:00 am–8:00 am AAPG House of Delegates' Breakfast, (by invitation only), Hilton 337AB, p. 17
- 7:00 am–8:00 am Judges' Breakfast, GRB CC Grand Ballroom B, p. 21
- 7:00 am–6:00 pm Registration, GRB CC Hall B3, p. 20
- 7:00 am–6:00 pm Speakers'/Judges' Room, GRB CC 330AB, p. 21
- 8:00 am–4:00 pm Spouse/Guest Hospitality, Hilton 340AB, p. 47
- 8:30 am–9:50 am Oral Session: Gulf Mega-Regional Seismic Interpretation, GRB CC Grand Ballroom A, p. 30
- 8:30 am–11:35 am Oral Session: Caribbean and Colombia Exploration, GRB CC Grand Ballroom C, p. 31
- 8:30 am–11:35 am Oral Session: Extracting Hydrocarbons from Source Rocks, GRB CC 320ABC, p. 32
- 8:30 am–6:00 pm Exhibitors/Posters Open, GRB CC Hall B3, pp. 25–30
- 8:55 am–11:35 am Oral Session: Salt Tectonics—Gulf of Mexico and the World, GRB CC 310ABC, p. 31
- 10:00 am–11:00 am Spouse/Guest Event: Feng Shui, Hilton 340AB, p. 47
- 10:15 am–11:35 am Oral Session: U.S. Gulf Deepwater Fields I, GRB CC Grand Ballroom A, pp. 30–31
- 11:45 am–12:50 pm All-Convention Luncheon, GRB CC Grand Ballroom B, p. 14
- 1:00 pm–2:00 pm Spouse/Guest Event: Seven Significant Signs of the Serious Liar?, Hilton 340AB, p. 47
- 1:05 pm–2:50 pm Oral Session: Geophysical Problem-Solving Technology, GRB CC 310 ABC, p. 33
- 1:05 pm–2:50 pm Oral Session: Rock Samples and Reservoir Analysis, GRB CC 320ABC, p. 34
- 1:05 pm–5:00 pm Oral Session: U.S. Gulf Deepwater Fields II, GRB CC Grand Ballroom A, p. 32
- 1:05 pm–5:00 pm Oral Session: Mexico Exploration and Opportunities, GRB CC Grand Ballroom C, pp. 33–34
- 3:15 pm–5:00 pm Oral Session: Global 3D Seismic Studies (GCSSEPM), GRB CC 310ABC, p. 33
- 3:15 pm–5:00 pm Oral Session: Advanced Studies of Petroleum Systems,



- 4:30 pm–6:00 pm GRB CC 320ABC, p. 34
 Presidents' Reception in Exhibit Hall, GRB CC Hall B3,
 p. 9
- 6:30 pm–9:30 pm BBQ, Beer, and Bytes—An Evening at St. Arnold Brewery,
 p. 9

Tuesday, September 22, 2015

- 7:00 am–8:00 am Speakers' and Poster Presenters' Breakfast, 360 ABDE,
 p. 20
- 7:00 am–12:00 noon Registration, GRB CC Hall B3, p. 20
- 7:00 am–5:00 pm Speakers'/Judges' Room, GRB CC 330AB, p. 21
- 8:00 am–3:00 pm Luggage Storage Room, GRB 350 A, p. 3
- 8:00 am–4:00 pm Spouse/Guest Hospitality, Hilton 340AB, p. 47
- 8:20 am–11:40 am GCAGS Education/Leadership Forum 2.0: Foundational
 Talks for the GOM I, GRB CC Gen. Assem. A, pp. 12, and
 34–35
- 8:30 am–11:30 am GCAGS Business Forum: Geologists as Leaders in
 Finance, Banking, and A&D, GRB CC 332DEF, pp. 12–13,
 and 36
- 8:30 am–11:35 am Oral Session: Onshore Gulf of Mexico Exploration I, GRB
 CC General Assembly B, p. 35
- 8:30 am–11:35 am Oral Session: Groundwater Environmental Case Studies,
 GRB CC 332ABC, p. 35
- 8:30 am–1:30 pm Exhibitors/Posters Open, GRB CC Hall B3, pp. 25–30
- 10:00 am–2:30 pm Spouse/Guest Event: Houston's Underground Walking
 Tour, p. 47
- 11:45 am–12:50 pm Exhibit Hall 'Walk & Talk' Box Lunch, GRB CC Hall B3,
 p. 11
- 11:45 am–12:50 pm DPA Luncheon, GRB CC 360ABDE, p. 14
- 11:45 am–12:50 pm GCSSEPM Luncheon, GRB CC 360CF, p. 14
- 1:05 pm–2:50 pm Oral Session: Coastal Geology and Environmental, GRB
 CC 332ABC, p. 35
- 1:05 pm–2:50 pm Oral Session: Seismic Attributes and Geophysical
 Technology, GRB CC 332DEF, pp. 37–38
- 1:05 pm–4:35 pm Oral Session: Onshore Gulf of Mexico Exploration II, GRB
 CC General Assembly B, pp. 36–37
- 1:15 pm–2:40 pm GCAGS Education/Leadership Forum 2.0: Foundational
 Talks for the GOM II, GRB CC Gen. Assem. A, pp. 12 and
 36
- 2:50 pm–3:15 pm Ice Cream Social/Coffee Break, GRB CC General
 Assembly Pre-Function



Chevron

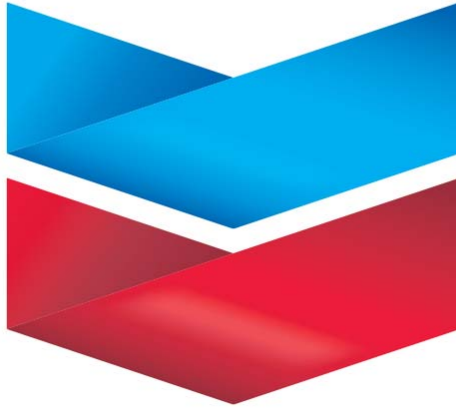

Diamond Sponsors



All events will be held at the George R. Brown Convention Center,
1001 Avenida de las Americas, Houston, Texas,
unless otherwise noted.

YOUNG PROFESSIONALS' AND STUDENTS' 'MEET & GREET' (Sponsored by Chevron)

Date: Sunday, September 20

Time: 3:30 pm–5:00 pm

Location: GRB CC Grand Ballroom Pre-Function Area

This 'Meet & Greet' will provide an early opportunity for young professionals and students to start the convention with a get-together. Experienced professionals are also invited to participate in this intergenerational discussion on the things that change and the things that don't in our profession. Drinks will be available. Following the reception, all are encouraged to attend the Opening Session and Awards Ceremony. For more information, please see page 45. **Entrance by badge only.**

OPENING SESSION

Date: Sunday, September 20

Time: 5:00 pm–6:00 pm

Location: GRB CC 310ABC

Join GCAGS President Charles Sternbach, GCSSEPM President Thomas Hearon, and General Chair Larry Bartell in welcoming attendees to Houston. The program will include welcoming remarks, the GCAGS/GCSSEPM awards ceremony, and an opportunity to meet candidates for 2016 AAPG officer positions. For more information, please see pages 22–23. **Entrance by badge only.**

AWARDS CEREMONY (at Opening Session)

Date: Sunday, September 20

Time: 5:00 pm–6:00 pm

Location: GRB CC 310ABC

The Awards Ceremony recognizes the 2015 recipients of GCAGS and GCSSEPM special honors, as well as the awardees of the best presentations and best published papers in the 2014 GCAGS Transactions and GCAGS Journal, all of whose works have made important contributions to GCAGS and the advancement of geosciences. For more information, please see pages 22–23. **Entrance by badge only.**

ICEBREAKER RECEPTION (Sponsored in part by Schlumberger)

Date: Sunday, September 20

Time: 6:00 pm–8:00 pm

Location: Exhibit Hall (GRB CC Hall B3)

If you can find any serious ice in a Houston September, break it at the Icebreaker. Join your friends and colleagues (old or brand new) to enjoy the food and drinks, have your first look at the exhibits and posters, and participate in the Treasure Hunt. Come pass a good time and get ready for the upcoming Convention. **Entrance by badge only.**

Schlumberger

ALL-CONVENTION LUNCHEON

Date: Monday, September 21
Time: 11:45 am–12:50 pm
Location: GRB CC Grand Ballroom B
Cost: \$50

Convention attendees are invited to attend the All-Convention Luncheon, where Ken Eisenmenger, Exploration General Manager, Deepwater Exploration and Projects Strategic Business Unit, Chevron North America Exploration and Production Company, will speak on “Chevron’s Key Discoveries and Developments in the Deepwater Gulf of Mexico, a Story of Steady Growth.” Space is limited, so check early at onsite registration for availability.

Entrance by badge only.

PRESIDENTS’ RECEPTION (Hosted by GCAGS President Charles Sternbach and GCSSEPM President Thomas Hearon)

Date: Monday, September 21
Time: 4:30 pm–6:00 pm
Location: Exhibit Hall (GRB CC Hall B3)

Join Charles Sternbach, President of GCAGS, Thomas Hearon, President of GCSSEPM, and Larry Bartell, General Chair, for a reception in the exhibit hall. We will have light refreshments and a cash bar. We will also recognize the 1st, 2nd, and 3rd place winners selected by the judges of the student posters. And, we will have a special competition described below. **Entrance by badge only.**

OLDEST GCAGS BAG CONTEST! (at Presidents’ Reception)

Date: Monday, September 21
Time: 5:00 pm–6:00 pm
Location: Exhibit Hall (GRB CC Hall B3)

As a celebratory event in observance of GCAGS’s 65th anniversary, we will honor the attendee who has the oldest GCAGS bag from previous conventions. If you are like most of us and you have a collection dating back farther than we care to admit, bring your candidate to the reception, because you may have the winner in your collection.

BBQ, BEER, and BYTES—An Evening at St. Arnold Brewery (Sponsored by Seitel, TGS, Subsurface Consultants & Associates, AAPG YP’s, and NeoGeos)

Date: Monday, September 21
Time: 6:30 pm–9:30 pm
Location: St. Arnold Brewery (2000 Lyons Ave.)
Cost: \$50

Most of us have known from our field camp days that beer has its place in our chosen field! Join your friends and colleagues for St. Arnold’s beer, Texas BBQ, door prizes, and both vintage and modern video games. Buses will provide transportation, with departures (first departure at 6:15 pm) from Avenida de las Americas adjacent to the Hilton Americas Houston Hotel, with return route (last return at 9:40 pm). Prizes will be raffled during the festivities. This event is limited to adults 21 and over.



GCAGS EDUCATION/LEADERSHIP FORUM 2.0: Foundational Talks for the Gulf of Mexico

Date: Tuesday, September 22

Time: 8:20 am–11:40 am & 1:15 pm–2:40 pm

Location: GRB CC General Assembly A

The Gulf of Mexico is one of the richest hydrocarbon provinces in the world, a “fertile crescent” of resources, technology, and ingenuity. GCAGS President Charles Sternbach has recruited globally recognized experts on the Gulf of Mexico to present foundational and timely talks of great interest to experienced and young professionals alike. Topics include large scale thinking on: New rules in Mexico, turbidite reservoirs, mega-regional structure, deepwater depositional systems, a story of success and unconventional work flows in the Eagle Ford shale, and carbonate reservoirs from Florida to Mexico.

Entrance by badge only.

GCAGS SPECIAL BUSINESS FORUM: Geologists as Leaders in Finance, Banking, and A&D

Date: Tuesday, September 22

Time: 8:30 am–11:30 am

Location: GRB CC 332DEF

The GCAGS Special Business Forum, “Geologists as Leaders in Finance, Banking and A&D – An Alternative to Traditional E&P Career Paths,” will be a moderated discussion with five geologists who also are industry leaders. Each panelist will give a short talk about their unique experience entering and adapting to the business and finance environment, followed by a lively round-table discussion, moderated by Steve Brachman and Jeff Lund, with audience participation. This will be an open forum. Topics will include, career opportunities, obtaining capital and cultivating relationships with capital providers (co-existing with MBA’s). **Entrance by badge only.**

WOMEN IN GEOSCIENCES TUESDAY MORNING BREAKFAST (Sponsored by Association for Women Geoscientists (AWG), Gulf Coast Association of Geologic Societies (GCAGS), and Pink Petro)

Date: Tuesday, September 22

Time: 7:00 am–8:30 am

Location: Hilton, Room 339AB

NOTE: Registration for this event is separate from the GCAGS Convention.

“Making the Most of Change & Difficult Times”, Keynote Speaker: CEO and Founder Pink Petro, Katie Mehnert. We live in uncertain times. Change and disruption are the new norms in our personal and professional lives. Join us for an engaging conversation about current industry changes and how you can survive and thrive. Gain new perspectives and tools to help you manage change for your career. Connect with professionals and students at this unique learning event and networking breakfast with women in Geoscience and Energy. **Entrance by badge only.**



Association for Women Geoscientists



EXHIBIT HALL 'WALK & TALK' BOX LUNCH

Date: Tuesday, September 22

Time: 11:45 am–12:50 pm

Location: Exhibit Hall B3

Cost: FREE for Professionals, Spouses, and Guests with your registration badge!

A free lunch and a final opportunity to visit the offerings of our exhibitors and to learn from the posters and their authors. The exhibition hall closes at 1:30 pm, so hurry over following the close of the morning's oral sessions. **Entrance by badge only.**

DPA LUNCHEON: How to Survive and Thrive in Good Times and Bad

Date: Tuesday, September 22

Time: 11:45 am–12:50 am

Location: GRB CC 360ABDE

Cost: \$50

Charles Goodson, Chairman of PetroQuest, will share his strategies for navigating the up and down cycles in the industry, with words of wisdom gained from a 40-year career and experience gained from leading both publicly traded and private companies. **Entrance by badge only.**

GCSSEPM LUNCHEON: Model the Rock! Using Diagenesis Simulation for Rock Property Prediction

Date: Tuesday, September 22

Time: 11:45 am–12:50 am

Location: GRB CC 360CF

Cost: \$50

Rob Lander works to understand controls on diagenetic processes in clastic rocks. He will describe recent advances in these studies and how they improve models of the textures and geomechanical and fluid-flow properties of rocks from deposition to reservoir conditions. **Entrance by badge only.**

PANEL DISCUSSION: Geo-Generations: 60 Years in the 'Patch' and Counting (Sponsored by AAPG Division of Professional Affairs)

Date: Tuesday, September 22

Time: 3:10 pm–4:30 pm

Location: GRB CC General Assembly A

In the Tinker family, at least, a passion for geoscience is hereditary! C. N. "Tom" Tinker is a retiree following a successful 39-year career with Shell Oil Company; his son Scott is director of the Texas Bureau of Economic Geology; and his son Nathan is a graduate student in geology at the University of Texas at Austin. During this facilitated panel discussion, Tom, Scott, and Nathan will consider industry, technology, science, political, and economic trends that have impacted and will continue to impact geoscientists in the oil and gas industry. We expect that they will tell some interesting family stories along sharing their wise and highly informed views on the large-scale influences on our profession. **Entrance by badge only.**

New Orleans Land & Exploration



GCAGS EDUCATION/LEADERSHIP FORUM 2.0

Foundational Talks for the Gulf of Mexico (Chaired by GCAGS President Charles Sternbach)

Date: Tuesday, September 22
Time: 8:20 am–11:40 am & 1:15 pm–2:40 pm
Location: GRB CC General Assembly A

The GCAGS Education/Leadership Forum 2.0 continues and expands on last year's Education Forum. Globally recognized big picture experts on the Gulf of Mexico will address key geoscience elements with mega-regional scale implications.

The speakers will be:

Scott W. Tinker – Texas State Geologist & Director, Bureau of Economic Geology (BEG),
John Dribus – Global Geosciences Advisor, Schlumberger,
Brian Horn – Vice President, ION Geophysical,
John Snedden – Director, Gulf Basin Depositional Synthesis Project,
Richard K. Stoneburner – Past President and COO, Petrohawk & AAPG Distinguished Lecturer, and
Charlie Kerans – Professor and R. K. Goldhammer Chair of Carbonate Geology, UT Austin.

Speakers will address foundational insights over broad Gulf of Mexico geography. Experienced and entry level geoscientists alike will benefit from broad perspectives. Leading Gulf of Mexico geoscientists will share hard won expertise gained over long and distinguished careers. Forum Chairman Charles Sternbach will guide the discussion. The audience will have many opportunities to learn from and question the best and brightest thought leaders on core topics of great importance to the Gulf of Mexico. **Entrance by badge only.**

GCAGS SPECIAL BUSINESS FORUM

Geologists as Leaders in Finance, Banking, and A&D—An Alternative to Traditional E&P Career Paths (Moderated by Steve Brachman and Jeff Lund)

Date: Tuesday, September 22
Time: 8:30 am–11:30 am
Location: GRB CC 332DEF

The GCAGS Special Business Forum, "Geologists as Leaders in Finance, Banking, and A&D—An Alternative to Traditional E&P Career Paths", will be a moderated discussion with five distinguished geologists who also are industry leaders.

The panelists will be:

Stuart Burbach – Nautilus Energy,
Andy Clifford – Saratoga Resources,

Jeff Jones – Van Operating & Quantum Energy Partners,
Dick Stoneburner – Pine Brook Partners, and
Tom Wilker – Carlyle Group.

Each panelist will give a short talk about their unique experience entering and adapting to the business and finance environment, followed by a lively round-table discussion, moderated by Steve Brachman and Jeff Lund, with audience participation.

The purpose of this forum is to show the different, less traditional avenues that geologists may take in their Energy careers – colorfully illustrated by five experts who successfully made the journey. This will be an open forum. Several topics will be discussed, including entering, surviving and prospering in the business world as a scientist, what type of career opportunities are available to the geologist, the nuts-and-bolts of obtaining capital and cultivating relationships with capital providers (or, co-existing with MBA's).

Entrance by badge only.

PANEL DISCUSSION

Geo Generations—60 Years in the 'Patch' and Counting (Moderated by Charles A. Sternbach) (Sponsored by AAPG Division of Professional Affairs)

Date: Tuesday, September 22

Time: 3:10 pm–4:30

Location: GRB CC General Assembly A

When C. N. "Tom" Tinker graduated from the University of Michigan in 1955 with an M.S. in Geology, he went to work for Shell Oil Company, retiring from Shell 39 years later after a full and satisfying career. "Old wireline logs. Low-resolution 2D seismic. Slide rulers. Oil was hard to find in those days," Tom said, "but easy to produce!"

When Scott W. Tinker graduated from the University of Michigan in 1985 with an M.S. in Geology, he had little expectation that he would work at the same company, or even in the same industry, for his full career. He worked for three oil and gas companies before joining the University of Texas at Austin in 2000. "In my industry years, computer technology exploded and we were making some of the first 3D computer reservoir models integrating core, log, and seismic data," recalls Scott. "It was a blast!"

Today, Nathan S. Tinker is working toward an M.S. degree in Geology at the University of Texas at Austin. "We are gathering massive amounts of digital outcrop data using drones; conducting full-basin analyses on integrated computer systems; and bringing in chemistry, physics, biology, and nanotechnology. Unconventional reservoirs are pretty easy to find, but really hard to produce!" laughs Nathan. "Who knows where my career will take me? But it will likely be around the world."

During their facilitated panel, Tom, Scott, and Nathan will consider industry, technology, science, political, and economic trends that have impacted and will continue to impact geoscientists in the oil and gas industry. And, of course, share a few fun stories along the way! **Entrance by badge only.**



ALL-CONVENTION LUNCHEON

“Chevron’s Key Discoveries and Developments in the Deepwater Gulf of Mexico, a Story of Steady Growth”

Ken Eisenmenger

(Exploration General Manager, Deepwater Exploration and Projects Strategic Business Unit, Chevron North America Exploration and Production Company)



Dates: Monday, September 21
Time: 11:45 am–12:50 pm
Location: GRB CC Grand Ballroom B
Cost: \$50

DPA LUNCHEON

“How to Survive and Thrive in Good Times and Bad”

Charles Goodson

(CEO of PetroQuest)



Date: Tuesday, September 22
Time: 11:45 am–12:50 pm
Location: GRB CC 360ABDE
Cost: \$50

GCSSEPM LUNCHEON

“Model the Rock! Using Diagenesis Simulation for Rock Property Prediction”

Rob H. Lander

(2014–15 AAPG Distinguished Lecturer, Scientific Advisor, Geocosm)



Date: Tuesday, September 22
Time: 11:45 am–12:50 pm
Location: GRB CC 360CF
Cost: \$50



WALTER OIL & GAS CORPORATION

Exhibit Hall Treasure Hunt!
**Exhibit hours Sunday-Tuesday Grand Prize Drawings at the
Prize Tumbler, Tuesday at 12:15 pm
(MUST BE PRESENT TO WIN!)**

Back for 2015! Explore the vendors booth by booth to find the exhibitor with the answers to the clues found on the card in your registration packet. Be the first to identify the mystery question correctly and receive a small gift from that exhibitor, then get the required authorized signature at the booth and move on to find the answer to the next clue on the flier. Once you have gathered all the signatures, you'll find a prize tumbler near the center of the hall; drop your card in the tumbler, and come back at 12:15 on Tuesday for the drawings of some great prizes. You must be present to win!

Oldest GCAGS Convention Bag
**Monday Evening during our Presidents' Reception, Exhibit Hall
(Hall B3)**

At our Monday evening Presidents' Reception on the Exhibit floor in observance of GCAGS's 65th anniversary, we will have as a celebratory event for this milestone a contest of who has the oldest GCAGS bag from previous conventions. If you are like most of us and have a collection dating back farther than we care to admit, bring your candidate to the reception, because you may have the winner in your collection. At the same time we recognize the oldest GCAGS bag, we will also recognize the first, second, and third place winners of the student poster presenters. **Entrance by badge only.**

BBQ, Beer, and Bytes—An Evening at St. Arnold Brewery
**Monday Night, 6:30 pm–9:30 pm • St. Arnold Brewery (2000
Lyons Ave.) • \$50 (Sponsored by Seitel, TGS, Subsurface
Consultants & Associates, AAPG YP's, and NeoGeos)**

Join your friends and colleagues for St. Arnold's beer, Texas BBQ, and both vintage and modern video games. Buses will provide transportation, departing from Avenida de las Americas adjacent to the Hilton Americas Houston Hotel, starting at 6:15 pm Monday night, with last return at 9:40 pm. Prizes will be raffled during the festivities. This event is limited to adults 21 and over. **Entrance by badge only.**

Women in Geosciences
Tuesday Morning Breakfast, 7:00 am–8:30 am • Hilton - 339AB
**• \$30 for Members of AWG/Pink Petro/Registered GCAGS
Conference Attendees; \$45 for all other Energy Professionals**

"Making the Most of Change & Difficult Times", Keynote Speaker: CEO and Founder Pink Petro, Katie Mehnert. We live in uncertain times. Change and disruption are the new norms in our personal and professional lives. Join us for an engaging conversation about current industry changes and how you can survive and thrive. Gain new perspectives and tools to help you manage change for your career. Connect with professionals and students at this unique learning event and networking breakfast with women in Geoscience and Energy. **Entrance by badge only.**



Exhibitor	Booth No.
2016 GCAGS Annual Convention	321
AAPG	436
Advanced Geosciences, Inc.	300
AGT	405
ALS Oil and Gas	226
BRUKER	328
Bureau of Economic Geology	404
Bureau of Ocean Energy Management	507
CGG	122–124–126
Chemostrat, Inc.	306–308
Core Mineralogy, Inc.	114
DownUnder GeoSolutions	407
Dynamic Graphics	238
Dynamic Measurement	435
Earthly Goods/Pierret Jewelers	503
East Texas Geological Society	138
Enthought	126–128
FairfieldNodal	406–408
GCAGS Bookstore	320
GCSSEPM Foundation	326
Gems & Crystals Unlimited	208
GeoCare Benefits Insurance	438
GeoFrontiers	420
Geomap Company	336
GeoMark Research, LTD.	236
Geophysical Insights	425–427
GETECH	335
Gravity Map Service/ Thompson Solutions, LLC	519
Horizon Well Logging, LLC	319
Horizontal Solutions International	304
Houston Geological Society	136
iBall Instruments	110
Integrated Geophysics Corporation	204
Interactive Exploration Solutions (INEXS)	530
ION Geophysical	201–203
Lafayette Geological Society	537
LMK Resources	521

Lynx Information Systems	303
MICRO-STRAT, Inc.	535
MUD Geochemical, Inc.	499
Neuralog	220
Paladin Geological Services	400
Paleo-Data, Inc.	422
PetroStrat, Inc.	299
PML Exploration Services LLC	104–106
Rock Solid Images (RSI)	108
Schlumberger	146
Seismic Exchange, Inc.	222
Selman & Associates	338
SEPM (Society for Sedimentary Geology)	399
SMART4D Geosteering	403
Task Fronterra Geoscience	112
TGS	200
The Leeds Group	528
Thompson Solutions, LLC/Gravity Map Service	519
Weatherford	502–504, 506–508–510

GCAGS Continuity Committee Meeting

Saturday, September 19, 5:30 pm–7:00 pm
Hilton Americas, Rm. 330

By invitation only.

GCAGS BOARD MEETING

Sunday, September 20, 8:00 am–2:00 pm
Hilton Americas, Rm. 339AB

GCAGS Officers, Committee Chairs, and Society Presidents or their representatives are invited to attend the Board Meeting. An invitation and RSVP was issued by GCAGS prior to the Convention.

AAPG House of Delegates' Breakfast

Monday, September 21, 7:00 am–8:00 am
Hilton Americas, Rm. Hilton 337AB

By invitation only.



We extend a very special thank you to our sponsors for supporting the 2015 GCAGS/GCSSEPM Annual Convention and Exhibition. Their continued support is fundamental to having a successful meeting.

Diamond

Chevron

Shell

Ruby

ExxonMobil Exploration Company

Sapphire

Anadarko Petroleum Corp.

American Shoreline Inc.

Five States Energy

Legends Exploration

Houston Energy

Walter Oil & Gas

Cabot Oil & Gas

Ion

BHP Billiton

Weatherford Laboratories

Noble Energy

Topaz

Schlumberger

Seitel

TGS

**Subsurface Consultants
& Associates**

StarCreek Exploration

In-Depth Geophysical

Auburn Energy

AAPG YP's

Exama

Halcon

Nexen

NeoGeos

Geophysical Insights

Topaz, cont.

SEIMAX Technologies
Seismic Exchange (SEI)
Energy XXI
Thunder Exploration

First Rock
Fugro
Repsol

Patron

Roxanna
Bill Whiting
Allen-Hoffman

White Marlin
New Orleans Land &
Exploration

Sponsors

ExxonMobil



American Shoreline, Inc.

Gifts for speakers, poster presenters, and judges
provided at generous discounts by Katy Rock Shop.



REGISTRATION

Location: Hall B3

Dates & Times:

Saturday, September 19	3:00 pm–6:00 pm
Sunday, September 20	7:00 am–8:00 pm
Monday, September 21	7:00 am–6:00 pm
Tuesday, September 22	7:00 am–12:00 noon

THE EXHIBITION

Location: Hall B3

Dates & Times:

Sunday, September 20 (Icebreaker)	6:00 pm–8:00 pm
Monday, September 21	8:30 am–6:00 pm
Tuesday, September 22	8:30 am–1:30 pm

THE GCAGS EXHIBITION—Where Geoscience Meets Industry: Networking, technology, information systems, and data all under one roof!

Explore the displays of scores of service companies, production companies, fossil and gem dealers, universities, research institutions, and publishers during the two and a half days of the exhibition. This is GCAGS's largest exhibition in years. Please support all those who have made this vital commitment to the success of the convention.

Need to check on emails or search for exhibitors' products and services on the Web? An Internet cafe is located in the exhibit hall. And although there is no free wifi elsewhere in the hall, you'll find several hotspots in the corridors and Grand Ballroom Prefunction area on Level 3.

Note: Children under the age of 13 will not be allowed in the Exhibit Hall anytime during setup or teardown. During exhibit hours, children not of school-age will not be allowed into any activities within the Exhibit Hall, including the Icebreaker reception, unless they are young enough or small enough to be confined to a stroller, backpack, or front pack. School-age children will be allowed to attend the exhibition during regularly scheduled hours if they are properly registered (as students) and they wear their badges at all times.

SPEAKERS' & POSTER PRESENTERS' BREAKFAST (Sponsored by Amshore)

Dates: Monday and Tuesday, September 21 & 22

Time: 7:00 am–8:00 am

Location: GRB CC Grand Ballroom B

All session chairs, speakers, and poster presenters are invited to attend this complimentary breakfast on the day of their presentations. Reminders will be given regarding session timing, audiovisual equipment, how speakers will be introduced, and when poster presenters must be in their booths, followed by a Q&A session.

JUDGES' BREAKFAST (Sponsored by Amshore)

Date: Monday, September 21 **ONLY**

Time: 7:00 am–8:00 am

Location: GRB CC Grand Ballroom B

All judges are invited to attend this complimentary breakfast on Monday. Information will be provided as to judging criteria and regarding which sessions to attend, and instructions and judging forms will be available at both the breakfast and in the Speakers' & Poster Presenters' Room/Judges' Tally Room.

SPEAKERS' & POSTER PRESENTERS' ROOM & JUDGES' TALLY ROOM

Locations: GRB CC 330AB

Dates & Times:

Sunday, September 20..... 1:00 pm–5:00 pm

Monday, September 21..... 7:00 am–6:00 pm

Tuesday, September 22..... 7:00 am–5:00 pm

STUDENT ACTIVITIES (Sponsored by Five States Energy)

In addition to specific student activities, including the 'meet & greet' and Imperial Barrel Award short course, this year's convention coincides with the AAPG-SEG Student Expo, at which students will present posters of their research. Students may also register for participation in convention activities on site through Tuesday noon, including service as student volunteers. See pages 44–45 for details.

TEACHER ACTIVITIES

The highly-regarded workshop "More! Rocks in your Head" is designed to support grade 3–12 educators by giving each teacher a greater personal knowledge of the Earth sciences along with a package of hands-on materials to promote understanding of the sciences in the classroom. See page 46 for details.

SPOUSE & GUEST ACTIVITIES (Sponsored by Auburn Energy and Exama Oil Company)

A variety of special activities have been arranged for spouses and guests, including a Hospitality Suite with interesting speakers and a walking tour that will explore the fascinating tunnel system of downtown Houston. For more information, please see page 47.

POSTER SESSIONS

The GCAGS 2015 poster sessions will take place in the exhibit hall (Hall B3) on the third floor of the George R. Brown Convention Center. Over 60 student research posters and 20 professional posters covering a diverse range of topics will be on view for the entire meeting (Sunday evening – Tuesday morning). Authors will be available for discussion during the coffee breaks on Monday morning (9:50 am–10:20 am) and afternoon (2:50 pm–3:20 pm). Student poster judging will occur on Monday and winning posters will be acknowledged at a special student awards ceremony in the exhibit hall on Monday evening. Everyone is invited to come help us celebrate all the students' hard work! For more information, please see pages 25–30.



OPENING SESSION AND AWARDS CEREMONY 5:00 pm–6:00 pm • Sunday, September 20 GRB CC 310ABC

GCAGS General Chair Larry Bartell, President Charles Sternbach, and GCSSEPM President Thomas Hearon will welcome attendees to the 65th annual GCAGS Convention. They will also honor individuals for exemplary service, presentations, and papers at the Awards Ceremony. **Entrance by badge only.**

The Awards Ceremony recognizes the 2015 recipients of GCAGS and GCSSEPM special honors, as well as the awardees of the best presentations and best published papers in the 2014 GCAGS Transactions and GCAGS Journal, all of whose works have made important contributions to GCAGS and the advancement of geosciences.

- The **GCAGS Transactions** (2015) will be dedicated to **John Amoruso**.
- The **GCAGS Distinguished Service Awards** (2015) will be presented to **Dallas Dunlap, Mike Quinn, and Mike Fein**.
- The **GCAGS Honorary Membership** (2015) will be presented to **Steve Hill**.
- The **Owen R. Hopkins Outstanding Earth Science Teacher Award** (2015) will be presented to **Ilena Krupala**.
- The **GCSSEPM Doris Curtis Malkin Medal** (2015) will be awarded to **Paul Weimer**.
- The **GCSSEPM Distinguished Service Award** (2015) will be presented to **Rick Beaubeouf**.
- The **2015 AAPG Gulf Coast Section Imperial Barrel Award – 1st Place, University of New Orleans; 2nd Place, University of Louisiana at Lafayette; and 3rd Place (tie), University of Texas at Austin and Stephen F. Austin State University**.
- The **2014 AAPG Gulf Coast Section A. I. Levorsen Memorial Award – John Snedden, Ian O. Norton, Gail L. Christeson, and Jason C. Sanford**, “Interaction of Deepwater Deposition and a Mid-Ocean Spreading Center, Eastern Gulf of Mexico Basin, USA”
- The **2014 Thomas A. Philpott Excellence of Presentation Awards** will be presented to:
 - 1st Place: Randy Broussard and Abu K. M. Sarwar** for their paper, “A Palinspastic Restoration for the Evolution of the Green Knoll Salt Dome in the Gulf of Mexico”
 - 2nd Place: Craig Fulthorpe, William E. Galloway, John W. Snedden, Patricia E. Ganey-Curry, and Timothy L. Whiteaker** for their paper, “New Insights into Cenozoic Depositional Systems of the Gulf of Mexico Basin”
 - 3rd Place: Tim Bennett** for his paper, “Seismic Amplitude Driven Marine Deltaic Facies Exploration—Examples of Stratigraphic Depositional Analogs in Southwestern Louisiana”
- The **2014 Gordon I. Atwater Best Poster Awards** will be presented to:
 - 1st Place: Catherine B. Enomoto** for her poster, “Well Log and 2D Seismic Data Character of the Wilcox Group in South-Central Louisiana”
 - 2nd Place: Dallas Dunlap** for his poster, “High-Resolution 3D Imaging of Quaternary Channelization: Offshore San Luis Pass, Texas”
 - 3rd place: Arthur S. Waterman and Richard H. Fillon** for their poster, “New Biostratigraphic and Paleoenvironmental Strategies for Defining and Identifying the Basinward ‘Edges’ of Ancient Continental Shelf Systems”

- The **2014 Grover E. Murray Best Published Paper Awards, *GCAGS Transactions***, will be presented to:
 - 1st place: Kathleen S. Haggar, Les R. Denham, and H. Roice Nelson, Jr.** for their paper, "Aquifers, Faults, Subsidence, and Lightning Databases"
 - 2nd place: C. Hans Nelson and John E. Damuth** for their paper, "Selected Highlights for 50 Years of Turbidite Studies since the Introduction of the Bouma Sequence"
 - 3rd place: Erik Scott and Wayne Abraham** for their paper, "Evaluating the Stratigraphy of a Paleo-Stepped Slope Profile, Offshore Northwestern Borneo"
- The **2014 President's Award for Outstanding Paper, *GCAGS Journal (vol. 3)***, will be presented to:
 - Robert G. Loucks and Robert M. Reed** for their paper, "Scanning-Electron-Microscope Petrographic Evidence for Distinguishing Organic-Matter Pores Associated with Depositional Organic Matter versus Migrated Organic Matter in Mudrock"



Sun., Sept. 20					Poster Session 1 & 2 (6:00 pm–8:00 pm) (Exhibit Hall)	
Mon., Sept. 21	Gulf Mega-Regional Seismic Interpretation (8:30 am–9:50 am) (Grand Ballroom A)	Salt Tectonics—Gulf of Mexico and the World (8:55 am– 11:35 am) (Room 310 ABC)	Caribbean and Colombia Ex- ploration (8:30 am–11:35 am) (Grand Ball- room C)	Extracting Hydrocarbons from Source Rocks (8:30 am–11:35 am) (Room 320 ABC)	Poster Session 1 & 2 (8:30 am– 6:00 pm) (Exhibit Hall B3)	
	All-Convention Luncheon (11:45 am–12:50 am) (Grand Ballroom B)					
Tues., Sept. 22	U.S. Gulf Deepwater Fields II (1:05 pm– 5:00 pm) (Grand Ball- room A)	Geophysical Problem- Solving Tech- nology (1:05 pm–2:50 pm) (Room 310 ABC)	Mexico Explora- tion and Opportunities (1:05 pm– 5:00 pm) (Grand Ball- room C)	Rock Samples and Reservoir Analysis (1:05 pm–2:50 pm) (Room 320 ABC)	Poster Session 1 & 2 (8:30 am–1:30 pm) (Exhibit Hall B3)	
			Global 3D Seismic Stud- ies (GCSSEPM) (3:15 pm– 5:00 pm) (Room 310 ABC)	Advanced Studies of Petroleum Systems (3:15 pm–5:00 pm) (Room 320 ABC)		
Tues., Sept. 22	GCAGS Education/ Leadership Forum 2.0: Foundational Talks for the Gulf of Mexico I (8:20 am–11:40 am) (General Assembly Area A)	Onshore Gulf of Mexico Exploration I (8:30 am– 11:35 am) (General Assembly Area B)	Groundwater Environmental Case Studies (8:30 am– 11:35 am) (Room 332 ABC)	GCAGS Special Business For- um: Geolo- gists as Lead- ers in Finance, Banking, and A&D (8:30 am –11:30 am) (Room 332 DEF)	Poster Session 1 & 2 (8:30 am–1:30 pm) (Exhibit Hall B3)	
	Exhibit Hall 'Walk & Talk' Box Lunch, (11:45 am–12:50 pm) (Exhibit Hall)					
	DPA Luncheon (11:45 am–12:50 pm) (Room 360ABDE)					
	GCSSEPM Luncheon (11:45 am–12:50 pm) (Room 360CF)					
	GCAGS Education/ Leadership Forum 2.0: Foundational Talks for the Gulf of Mexico II (1:15 pm–2:40 pm) (General Assembly Area A)	Seismic Attrib- utes and Geo- physical Tech- nology (1:05 pm–2:50 pm) (Room 332DEF)	Environmental and Coastal Geology (1:05 pm–2:50 pm) (Room 332ABC)	Onshore Gulf of Mexico Exploration II (1:05 pm–4:35 pm) (General Assembly Area B)	Ice Cream Social/Coffee Break, (2:50 pm–3:15 pm) (General Assembly)	
Ice Cream Social/Coffee Break, (2:50 pm–3:15 pm) (General Assembly)						
Panel Discussion (3:10 pm–4:30 pm) (General Assembly Area A)	New Ideas in Mapping and Exploration (3:15 pm–4:35 pm) (Room 332DEF)	Chemostratig- raphy and Paleontology (3:15 pm–5:00 pm) (Room 332ABC)	Onshore Gulf of Mexico Exploration II (1:05 pm–4:35 pm) (General Assembly Area B)			

All sessions will be held at the George R. Brown Convention Center.
Poster Sessions: George R. Brown Third Floor Exhibit Hall
Oral Sessions: Grand Ballrooms A and C, General Assembly Areas A and B, and Rooms 310ABC, 320ABC, 332ABC, and 332DEF
Luncheons: Grand Ballroom B, and Rooms 360ABDE and 360CF

**SUNDAY (6:00 pm–8:00 pm),
ALL DAY MONDAY (8:30 am–6:00 pm) & TUESDAY
(8:30 am–1:30 pm) MORNING, SEPTEMBER 20–22**

– POSTER SESSION 1: PROFESSIONAL –
(George R. Brown Third Floor Exhibit Hall B3)
Session Chair: Meredith Faber

MEXICO AND CARIBBEAN PLAYS

- Erik Medina Romero, Universidad Nacional Autonoma de Mexico:** Regional Study to Find Prospects for Geological Storage of CO₂ in the Burgos Basin
- Juan Carlos Silva Tamayo, University of Houston:** Changes in Eocene-Miocene Shallow Marine Carbonate Factories along the Tropical SE Circum-Caribbean Responded to Major Regional and Global Environmental and Tectonic Events
- David King, Auburn University:** Stratigraphic Correlation of Cretaceous-Paleogene ('KT') Boundary Sections, Northern Belize

COASTAL GEOLOGY AND SURFACE IMPACT

- Douglas Carlson:** Changes of Global Sea-Level Rise and Relative Sea-Level Rise in Coastal Louisiana in the 21st Century
- Kelly Haggard, Riparian, Inc:** Legal Aspects of Coastal Change

GOM SHELF AND ONSHORE PLAYS

- Jennifer Eoff, U.S. Geological Survey:** Geologic Framework for the Assessment of Undiscovered Oil and Gas Resources in Sandstone Reservoirs of the Upper Jurassic–Lower Cretaceous Cotton Valley Group, U.S. Gulf of Mexico Region
- Paul Heinrich, Louisiana Geological Survey:** Late Quaternary Stratigraphic Evolution of the Southwestern Louisiana Inner Continental Shelf: Paleo-Landscape Preservation Potential and Implications for Offshore Sand Resources
- Benjamin Rendall, ExxonMobil Upstream Research Company:** Impact of Microporosity-Dominated Carbonate Pore System on Production in the Edwards A, Word Field, Central Texas

PORTFOLIO MANAGEMENT

- Thomas Lacombe, Louisiana State University:** Importance of Translation Services in the Energy Sector



James MacKay, Rose and Associates: Comparing the Results of the Kelly Criterion and Risk Aversion: Quick Look Practical Alternatives to Portfolio Optimization

GULF OF MEXICO DEEPWATER

Alessio Checconi, TGS: Post Well Analysis of Gulf of Mexico: A Multidisciplinary Approach for a More Confident Understanding of this Complex Petroleum System

Yangyang Li, C&C Reservoirs: Reducing Uncertainties and Risks in Exploration and Development in the Gulf of Mexico Basin—Insights Gained from Analysis of over 100 Reservoir Analogs

Victor Jones, Exploration Technology Inc.: Natural Hydrocarbon Seeps: Toward Understanding a Complex Natural System

Selim Shaker, G.A.S.: A New Approach to Pore Pressure Predictions: Generation, Expulsion, and Retention Trio—Case Histories from the Gulf of Mexico

TECHNOLOGY

Alexander Seyfarth, Bruker: Strategy for Developing and Calibrating Shale and Mudstone Chemostratigraphies Using Handheld X-Ray Fluorescence Units and Its Use on an Automated Core Scanner

Selim Shaker, G.A.S.: A New Perspective to Shallow Water Flow (SWF) and Sinking Well-Head Preventions in Deep Water

Mike Sheahan, Summit Discovery Resources: Understanding Well Performance by Using Elemental Ratios in the Wolfcamp Formation, Midland Basin

Thomas Yancey, Texas A&M University: Rates of Sediment Deposition during the Late Eocene of Central Texas Based on $^{40}\text{Ar}/^{39}\text{Ar}$ Dating of Volcanic Ash

Sharma Dronamraju, AKD Professional Solutions: A Success Case of Revival of an 80 Year Old Oilfield through New 3D Seismic Interpretation and Reservoir Modeling, Lak Ranch, Weston County, Wyoming, USA

– POSTER SESSION 2: STUDENT – (George R. Brown Third Floor Exhibit Hall B3)

Session Chair: Meredith Faber

MEXICO AND CARIBBEAN PLAYS

Luis Carlos Carvajal, University of Houston: Western Caribbean Structural Provinces Based on 2D Kinematic Restorations of the Lower Nicaraguan Rise and Colombia Basin

Shenelle Gomez, University of Houston: Tectonic Evolution and Hydrocarbon Prospectivity of the Tobago Forearc Basin, Barbados Ridge, and Barbados Accretionary Prism

David Lankford-Bravo, University of Houston: Influence of Basement Dip on Morphological and Structural Characteristics of the Perdido–Port Isabel and Northern and Southern Mexican Ridges, Western Gulf of Mexico

Usama Yarbuh, CICESE: The Interplay between Deformation, Erosion, and Sedimentation in the Deepwater Mexican Ridges Fold Belt, Western Gulf of Mexico Basin

Gift Ntuli, Baylor University: Ps Receiver Function Imaging of the Northeast Caribbean Plate Boundary

Patrick Loureiro, University of Houston: Hydrocarbon Potential of Hispaniola and Puerto Rico Based on Combining Depth to Basement and Maturity Information from Previous Wells

Maria Squier, University of Houston: Observing Oil Surface Area Due to Seepage in Lake Maracaibo

CARBONATES

Khaled Amrouni, Texas A&M University: Sequence Stratigraphy, Chemostratigraphy, and Diagenesis of the Cyrenaican Miocene Carbonate-Evaporite Successions, NE Libya

Khaled Amrouni, Texas A&M University: Sedimentology and Sequence Stratigraphy of the Upper Miocene Carbonate-Evaporite Sequence of the Wadi Yunis Member, Al-Khums Formation, Sirt Basin, Libya

William Bailey, University of Oklahoma: Fault Plane Geomorphology and Structural Analysis of a Middle Eastern Giant Carbonate Oil Field

Derek Sullivan, Stephen F. Austin University: Megaposity Development within the Central Tennessee Basin: A Comparative Study of Karst in Middle-Upper Ordovician Strata

Michelle Rimmell, Stephen F. Austin University: Stratigraphy, Sedimentology, and Diagenesis of Ordovician Carbonates in Maury County, Tennessee

Ashley Landers, Stephen F. Austin University: Karst Development within the Salado Creek Watershed, Williamson and Bell Counties, Central Texas

Caroline Broderick, Louisiana State University: Tracing Suspended Sediment in the Subsurface Using Beryllium-7 Isotope

COASTAL GEOLOGY/SURFACE IMPACT/ENVIRONMENTAL GEOLOGY

Nur Ahmed, Auburn University: Mixing Mechanism and Salinity Ingression at the Coastal Aquifers of the Bengal Delta

Chang Liu, Louisiana State University: Monsoon Intensity and its Impact on the Chemical Weathering during Glacial Cycle in the South China Sea

Yuting Li, Louisiana State University: Sediment Flux through the Indus Submarine Canyon, Arabian Sea

Pankaj Khanna, Rice University: Modeling Upper Cambrian Microbial Reefs: Bridging the Gap from Outcrops to Reservoir Scale

Lu Zhu, Southern Methodist University: Early Permian Paleosol Morphologies and Paleo-Atmospheric pCO₂ Estimates, North-Central Texas

Ashley Ramsey, Baylor University: Assessing the Radiocarbon Landscape Reservoir Effect of Gastropods from Central Texas to Increase the Accuracy and the Precision of Radiocarbon Dating of Past River Systems

Drew Daymond, Auburn University: Trace Fossil Origin for Pervasive Pyritized Films in the Estuarine Ingersoll Shale, Cretaceous Eutaw Formation, Eastern Alabama

Christopher Odezulu, Rice University: Follets Island: A Case Study of a Dying Barrier Island

SEDIMENTOLOGY

Kyle Ayers, Stephen F. Austin University: Geochemical Analysis of Stanley Shale Concretions in Southern Oklahoma



- Matthew McCarter, University of Tulsa:** Permeability Anisotropy Study of the Bluejacket Sandstone at OK-20 Roadcuts in Eastern Mayes County, Oklahoma
- Kivanc Biber, University of Houston:** Quantitative Characterization of Shale Drapes within the Tidally-Influenced Fluvial Valley-Fill Deposits of the Ferron Sandstone, Utah—Implications for Subsurface Exploration
- Katie McKay, University of Alabama:** The Effects of Cave Ventilation on Stalagmite Deposition and Paleoclimate Records—A Case Study from Cathedral Caverns, Alabama
- Kyle Deatrick, University of Texas at El Paso:** Depositional Facies and Geometry of an Exposed Megaflap: Pennsylvanian Honaker Trail Formation, Gypsum Valley Salt Wall, Paradox Basin, Colorado
- Shazia Hart, University of Texas of the Permian Basin:** Study of Producing Ramsey Sandstones in the Bell Canyon Formation of the Delaware Basin: Paduca Field, Lea County, New Mexico
- Wesley Turner, Stephen F. Austin University:** Quantitative Mineralogic Analysis of Wolfcamp Shale in Crockett County, Texas through X-Ray Diffraction
- Caitlin Leslie, Baylor University:** Reservoir Characterization and Petrofacies Model for the Devonian Grosmont and Upper Ireton Formations, Northeastern Alberta, Canada
- Clint Miller, Rice University:** Low Methane Concentrations in Sediment along the Siberian Slope: Inference from Pore Water Geochemistry

STRATIGRAPHY

- Maria Gutierrez, Texas A&M University:** Study of the Spatial Variations in Eolian Stratigraphic Architecture in the Norphlet Formation, Southwestern Alabama
- Ziaul Haque, Auburn University:** Detrital History of the Conglomerate Measures of the Pottsville Formation in the Cahaba Synclinorium, Southern Appalachians, Alabama
- Jason Fisher, Auburn University:** Stratigraphy of the Toledo Formation, Belize Basin, Southern Belize
- Mindy Shaw-Faulkner, Stephen F. Austin University:** Paleostratigraphic Biofacies and Lithofacies of the Owl Mountain Province, Fort Hood Military Installation, Bell and Coryell Counties, Texas
- Adewale Amosu, Texas A&M University:** An Angular Unconformity between the Woodbine and Eagle Ford Formations in Delta and Hunt Counties of the East Texas Basin

STRUCTURAL GEOLOGY

- Meredith Bush, University of Texas at Austin:** Laramide Deformation along the Southern Rocky Mountain Front: Provenance Record from the Raton and Galisteo-El Rito Basins of Colorado and New Mexico
- Alexander Cheney, University of Houston:** Foreland Deformation Related to Precambrian Features of the Permian Basin of West Texas and New Mexico
- Brady Nock, University of Texas at San Antonio:** Comparison of Permeability Calculated from Geophysical Logs, Aquifer Tests, and Grain-Size Distribution at SAWS Aquifer Storage and Recovery Site, Bexar County, Texas
- Ingrid Eckhoff, Stephen F. Austin University:** Structural Control on Fluid Migration in the Northern Segment of the Edwards Balcones Fault Zone Aquifer, Central Texas

SALT TECTONICS AND TRAPS

- Derek Scott, University of Houston:** Controls of Salt Tectonics and Shortening on Hydrocarbon Prospectivity in Passive Margin Fold Belts of Offshore Gabon
- Allison Mast, University of Texas at El Paso:** Petrographic, Halokinetic, and Structural Analysis of Permian-Age Carbonate Caprock at Gypsum Valley Salt Wall, Paradox Basin, Colorado
- Elizabeth Heness, University of Texas at El Paso:** Salt Tectonic Controls on Facies and Sequence Stratigraphy of the Triassic Chinle Formation, Gypsum Valley Salt Wall, Colorado

GEOLOGY-GEOPHYSICS-ENGINEERING

- Brandon Rasaka, Baylor University:** Correlation of Earthquakes with Seismogenic Faults, Central Oklahoma
- Kenton Shaw, Baylor University:** Geodetic Constraints on Deformation and Earthquake Focal Mechanisms in the Dominican Republic
- Matt Worrell, Stephen F. Austin University:** Seismic Reconstruction and Petroleum System Analysis of the Norphlet Formation in the Mississippi Canyon, Gulf of Mexico, Using 3D Seismic Data
- Yiduo Liu, University of Houston:** Slab Tearing Triggered the Cretaceous Igneous Activity in the Northern Gulf of Mexico Region

GEOPHYSICAL TECHNOLOGY

- Kevin Worley, Stephen F. Austin University:** Spatial Delineation and Classification of Surficial Karst Manifestations Utilizing LiDAR, Fort Hood Military Installation, Central Texas
- Lei Sun, University of Houston:** Ground-Based Hyperspectral Remote Sensing and Terrestrial Laser Scanning of the Eagle Ford Formation
- Kyle Altimore, Stephen F. Austin University:** Delineation of Surficial Karst Manifestations using LiDAR and Pictometry in Ordovician Carbonates, Central Texas
- Garrett Harris, Stephen F. Austin University:** Evaluation of Groundwater Quality in Paleozoic Aquifers Using GIS Techniques, Central Texas
- Robert Singleton, Auburn University:** Gravity and Magnetic Modeling of the Black Warrior Basin, Cahaba Basin, and Valley and Ridge, Central Alabama
- Brittany Gregory, Louisiana State University:** Trials of Near-Surface Geophysics at Archeological Sites in SE Louisiana
- Mohit Agrawal, Baylor University:** Receiver Functions and Surface Wave Dispersion Modeling of the Crust and Upper Mantle beneath the Texas Gulf Coast
- Mason MacPhail, Southern Methodist University:** Seismic Source Characterization of Small-Scale Contained Explosions Utilizing Near Source Empirical Data
- Sasha Gumprecht, University of London:** Tectono-Stratigraphic Evolution of the Centaur 3D Survey, Exmouth Plateau, North West Shelf Australia

UNCONVENTIONAL PLAYS

- Samiha Naseem, Louisiana State University:** Wavelet Transformation as a Reservoir Characterization Tool in Shale Plays
- Ryan Feiner, University of Alabama:** Well Log Clustering Analysis and Upscaling Procedure of the Tuscaloosa Marine Shale, Mississippi and Louisiana



- Shanna Mason, University of Louisiana at Lafayette:** Structural Characterization of the Eagle Ford Formation, Val Verde County, Texas
- Kaytan Kelkar, Texas A&M University:** Thickness Variation of the Eagle Ford and Adjacent Strata in Bureson, Lee, and Washington Counties, Texas
- John Dabney, Texas A&M University:** Using pXRF to Identify Pay Zones in Hydrocarbon-Rich Shales: A Litho-Geochemical Analysis of the Eagle Ford Shale
- Talban Kantala, Stephen F. Austin University:** Exploring the Weches Formation as a Potential Unconventional Oil and Gas Resource in Sabine County, Texas
- Sarah Beers, Texas A&M University at Kingsville:** Evidence of Precambrian Organic --Rich Shales in a Granitic Pegmatite, Llano County, Texas
- Joseph Sortore, University of Texas at Arlington:** Fracture and Pore Network Connectivity in Shales Related to Increased Hydrocarbon Production
- Richard Goldberg, University of Texas at Arlington:** Testing Radiogenic Strontium to Determine Provenance of Dissolved Solids in North Texas

MONDAY MORNING, SEPTEMBER 21

—ORAL SESSIONS—

GULF MEGA-REGIONAL SEISMIC INTERPRETATION (Grand Ballroom A)

Session Chairs: Barbara Radovich and Ed Haire

- 8:30** **OPENING REMARKS**
- 8:35** **Ed Haire, ION:** Onshore Florida Interpretation Utilizing Composited PSDM Seismic Data Integrated with a Mega-Regional Basinwide Gulf of Mexico PSDM Seismic Program
- 9:00** **Barbara Radovich, ION:** Correlation of Events for the Jurassic and Cretaceous of the Northern Gulf of Mexico Margin Using Mega-Regional Onshore/Offshore-Composited PSDM Seismic Grid
- 9:25** **James Pindell, ION:** Structure Maps of the Top-Rift Unconformity/Oceanic Crust and Top Cretaceous Surfaces, and the Oxfordian Rift-Drift Reconstruction, Gulf of Mexico

U.S. GULF DEEPWATER FIELDS I (Grand Ballroom A)

Session Chairs: Clint Moore and Justin Vandenbrink

- 10:15** **OPENING REMARKS**
- 10:20** **Elizabeth Watkins, Petrobras:** A Geology-Based, Non-Seismic Attribute Method to Generate Facies, Lithology, and Petrophysical Parameters in the Chinook and Cascade Fields, Walker Ridge, Gulf of Mexico, USA
- 10:45** **Frank Evans, Chevron:** Advances in the Tahiti Field Subsalt Seismic Imaging and Interpretation: Utilizing Seismic Attribute Analysis and Offset/Azimuth Partitions for Imaging and Interpreting Deepwater Subsalt Structure and Facies
- 11:10** **Pilar Rojas, Shell:** The Road to Shell's Appomattox Discovery

SALT TECTONICS—GULF OF MEXICO AND THE WORLD
(Room 310ABC)

Session Chairs: Rachele Kernan and Aubrey Collie

- 8:55** **OPENING REMARKS**
- 9:00** **Shankar Mitra and Pierre Karam, University of Oklahoma:** Controls of Shapes and Evolution of Salt Diapirs: Experimental Studies
- 9:25** **Abah Omale and Juan Lorenzo, Louisiana State University:** Using Fault Kinematics to Evaluate the Relationship between Cenozoic Fault Activity, Sedimentation Rates, and Salt Movement in the Gulf of Mexico: A Comparison between Southwestern and Southeastern Louisiana
- 9:50** **BREAK**
- 10:20** **Aubrey Collie, University of Texas at El Paso:** Facies Distribution and Halokinetic Sequence Stratigraphy of Lower Cambrian Carbonate Strata adjacent to Wirrealpa Diapir, a Secondary Salt Diapir in the Central Flinders Ranges, South Australia
- 10:45** **Joshua McFarland, University of Texas at El Paso:** Structural and Stratigraphic Development of a Salt-Diapir Shoulder, Gypsum Valley Salt Wall, Paradox Basin, Colorado
- 11:10** **Constantin Platon, Shell:** Salt-Sediment Interaction and Passive Diapirism: A Field-Based Story of La Popa Salt Diapir Rise Coeval with Deposition of Viento Formation, La Popa Basin, NE Mexico

CARIBBEAN AND COLOMBIA EXPLORATION
(Grand Ballroom C)

Session Chairs: Robert Erlich and Paul Mann

- 8:30** **OPENING REMARKS**
- 8:35** **Robert Erlich, Pan Atlantic:** Petroleum Potential of the Florida-Cuba-Bahamas Collision Zone
- 9:00** **Bryan Ott, University of Houston:** What Lies beneath the Tip of the Iceberg? Late Cretaceous to Recent Tectonic Evolution of Jamaica and the Nicaraguan Rise with Implications for a Widespread Eocene Petroleum System
- 9:25** **Carlos Sanchez, University of Houston:** Cenozoic Structural, Deformational, and Erosional Events Observed Along a 400-km Long, Onshore-to-Offshore Regional Transect Across Northwestern South America
- 9:50** **BREAK**
- 10:20** **James Pindell, Tectonic Analysis:** Role of Caribbean Tectonics in the Tectono-Stratigraphic Evolution of Southern Mexico and the Gulf of Mexico
- 10:45** **Stephen Leslie, PanAtlantic:** Petroleum Systems of the Tayrona-Rancheria Basin, Offshore Guajira Peninsula, Colombia
- 11:10** **Rocio Bernal Olaya, University of Houston:** Tectonostratigraphic Evolution of the Lower Magdalena Basin, Colombia: An Example of an Underfilled to Overfilled Forearc Basin

EXTRACTING HYDROCARBONS FROM SOURCE ROCKS
(Room 320ABC)

Session Chairs: Sharma Dronamraju

- 8:30** **OPENING REMARKS**
- 8:35** **Malleswar Yenugu, IKON:** Source Rock Maturation: Its Effect on Porosity and Anisotropy in Unconventional Resource Plays



- 9:00** **Manas Pathak, University of Utah:** Examination of the Generation of Overpressure in the Eagle Ford
- 9:25** **Rick Schrynemeekers, AGI:** Optimizing Lateral Placement and Production while Minimizing Completion Costs: An Eagle Ford Case Study
- 9:50** **BREAK**
- 10:20** **Gary Hanson, Louisiana State University:** Evolution of Challenges to the Development of Unconventional Oil and Gas Resources
- 10:45** **Tom Arnold, Paladin:** Case Study: Woodford Shale Source Rock Characterization by Geochemical and SEM Evaluation in a Horizontal Well
- 11:10** **Robert Reed, BEG:** Low-Thermal-Maturity (<0.7% VR) Mudrock Pore Systems: Mississippian Barnett Shale, Southern Fort Worth Basin

MONDAY AFTERNOON, SEPTEMBER 21

—ORAL SESSIONS—

U.S. GULF DEEPWATER FIELDS II (Grand Ballroom A)

Session Chairs: Clint Moore and Justin Vandenbrink

- 1:05** **OPENING REMARKS**
- 1:10** **Paul Jaeger, Anadarko:** The Lucius Exploration Story: An Ultra-Deepwater Subsalt Pliocene Discovery
- 1:35** **Shawn Kushiya, Shell:** Stones Field: Deep and Distant
- 2:00** **Christopher Walker, BP:** Compartmentalization between the GC0738_1 Mad Dog North Wellbores—Evidence for Post-Depositional Slumping in the Lower Miocene Reservoirs of the Deepwater Southern Green Canyon, Gulf of Mexico
- 2:25** **V. Nekhorosheva and Amanda Ardill, Shell:** Streamlined Modeling and Simulation Approach to Evaluating Waterflood Potential in Ursa Princess Field, Mars Basin, U.S. Gulf of Mexico
- 2:50** **BREAK**
- 3:20** **Cynthia Blankenship, BP:** From Moratorium to 10 Rigs—BP in the Deepwater Gulf of Mexico 2010 to 2015
- 3:45** **Clint Moore and Mike Neese, Gultslope:** Deepwater Subsalt-Suprasalt Middle-Lower Slope Sands and Reservoirs of the U.S. Gulf of Mexico: The Evolution of an Exciting Giant Field Concept
- 4:10** **Wesley Cantwell, Schlumberger:** Redefining Geological Evaluation in Deepwater Using New High-Resolution Borehole Imaging Technology
- 4:35** **Oluwayomi Oyedele, GEMS:** Seismic Facies Analysis and Age Dating of Mid-Pleistocene Channel-Lobe Deposits, Mad Dog Field, Gulf of Mexico

GEOPHYSICAL PROBLEM-SOLVING TECHNOLOGY (Room 310ABC)

Session Chairs: Selim Shaker and Steve Getz

- 1:05** **OPENING REMARKS**
- 1:10** **Selim Shaker, GAS:** Prediction of Seal Failure and Reservoir Breaching in Deep Water
- 1:35** **Yogesh Agnihotri, CGG:** Salt Delineation Using Vector Offset Output (VOO) of Full Azimuth Data
- 2:00** **Nicholas Brooks, READ:** Defining a Steeply-Dipping Salt Flank in Mississippi with a New High-Certainty 3D Method

2:25 Laurence Corbett, Schlumberger: Dynamic Datasets Using Forward Modeling to Reduce Uncertainty and Improve Recovery

GLOBAL 3D SEISMIC STUDIES (GCSSEPM)
(Room 310ABC)

Session Chairs: Erik Scott and Thomas Hearon

3:15 OPENING REMARKS

3:20 Erik Scott, Talisman: Integration of Well, Core, and Seismic Data for 3D Depositional Environment and Reservoir Architecture Interpretation—Example from Offshore Vietnam

3:45 Jacob Covault, Chevron: Reservoir Architecture and Stratigraphic Evolution of Channelized Deepwater Depositional Systems

4:10 Tom Wooltorton, ffa: Shallow Hazard and Gas Escape Systems Modelling from 3D Seismic Data

4:35 Sasha Gumprecht, University of London: Tectono-Stratigraphic Evolution of the Centaur 3D Survey, Exmouth Plateau, North West Shelf Australia

MEXICO EXPLORATION AND OPPORTUNITIES
(Grand Ballroom C)

Session Chairs: Ricardo Padilla y Sanchez and Anthony Rodriguez

1:05 OPENING REMARKS

1:10 Ricardo Padilla y Sanchez, Nacional: The Lower Mesozoic Rocks of Mexico Revisited

1:35 Edgar Rangel-German, NHC: Energy Reform in Mexico

2:00 Craig Davis, INEXS: Overview of the Petroleum Basins of Mexico

2:25 Paul Mann, University of Houston: New Insights into the Mesozoic Evolution of the Gulf of Mexico Basin from Gravity and Deep- Penetration Seismic Reflection Data

2:50 BREAK

3:20 Usama Yarbuh, CICESE: The Interplay between Deformation, Erosion, and Sedimentation in the Deepwater Mexican Ridges Fold Belt, Western Gulf of Mexico Basin

3:45 Stephen Cossey and Don Van Niewenhuise, Cossey and Associates; University of Houston: The Chicontepec Formation, Onshore Eastern Mexico: Compelling Evidence for the Eocene Gulf of Mexico Drawdown Theory

4:10 Guillermo Perez Cruz, Universidad Nacional Autonoma de Mexico: The Role of Seismic Technology to Unravel the Hydrocarbon Potential of Mexican Basins

4:35 Erik Medina Romero, Universidad Nacional Autonoma de Mexico: Regional Study to Find Prospects for Geological Storage of CO₂ in the Burgos Basin

ROCK SAMPLES AND RESERVOIR ANALYSIS
(Room 320ABC)

Session Chairs: Robert Merrill and Dallas Dunlap

1:05 OPENING REMARKS

1:10 Robert Merrill, Catheart: Visual Rock Characterization Can Benefit Reservoir Analysis



- 1:35 Konstandinos Zamfes, PSI:** Drilling Cutting Analysis and Geo-Algorithm Conversion to Petrophysics
- 2:00 Harry Rowe, University of Texas at Austin:** Chemostratigraphic Applications of Handheld X-Ray Fluorescence to Mudrock Plays: Methods, Pitfalls, Limitations, Aspirations, and Good Examples
- 2:25 Konstandinos Zamfes, PSI:** OPAL: On Surface Petrophysical Analytical Logging—New Petrophysical Measurement Principles on Drilling Cuttings While Drilling

ADVANCED STUDIES OF PETROLEUM SYSTEMS (Room 320ABC)

Session Chairs: Dallas Dunlap and Robert Merrill

- 3:15 OPENING REMARKS**
- 3:20 Gary Rice, GeoFrontiers:** The Vertical Migration Model and Recent Advances in Geochemical Exploration
- 3:45 Richard Bishop, Consultant:** Implications of Source Overcharge for Prospect Assessment
- 4:10 Rick Schrynemeeckers, AGI:** Improving Petroleum System Identification in Offshore Salt Environments: Gulf of Mexico and Red Sea Case Studies
- 4:35 Jeffrey Nunn, Louisiana State University:** Spatial Variations in Pore Water Salinity: Implications for Fluid Pathways and Compartmentalization in a Deepwater Gulf of Mexico Field

TUESDAY MORNING, SEPTEMBER 22 —ORAL SESSIONS—

GCAGS EDUCATION/LEADERSHIP FORUM 2.0: Foundational Talks for the Gulf of Mexico I (General Assembly Area A)

Forum Chair: Charles Sternbach

- 8:20 Charles Sternbach:** Introduction
- 8:30 Scott W. Tinker, BEG:** Opening Mexico: A Bold Initiative at a Critical Time
- 9:10 John Dribus, Schlumberger:** Reservoir Characteristics of Turbidite Depositional Facies and Key Risks for Basin Floor Fan Turbidite Reservoirs
- 9:50 BREAK**
- 10:20 Brian Horn, ION:** Regional Mapping across the Entire Gulf of Mexico Basin—New Plays and New Perspectives
- 11:00 John Snedden, GBDSP:** The Geologic History of Submarine Fans in the Deepwater Gulf of Mexico: Mesozoic to Modern

ONSHORE GULF OF MEXICO EXPLORATION I (General Assembly Area B)

Session Chairs: Tim Rynott and Tom Ewing

- 8:30 OPENING REMARKS**
- 8:35 Tom Ewing, Frontera:** Opening of the Gulf of Mexico and Origins of the Gulf Coast Basin: Review and a Revised Working Model

- 9:00 Art Donovan, BP:** Chronostratigraphic Relationships of the Woodbine and Eagle Ford Groups across Texas
- 9:25 Robert Loucks, BEG:** Analysis of Pore Networks and Reservoir Quality of the Upper Cretaceous Woodbine Sandstone in the High-Recovery-Efficiency, Giant East Texas Field
- 9:50 BREAK**
- 10:20 Shirley Dutton, BEG:** Factors Controlling Permeability Variation in Onshore, Deep Paleogene Wilcox Sandstones in the Northern Gulf of Mexico Basin: Targeting High-Quality Reservoirs
- 10:45 William Ambrose, BEG:** Sequence-Stratigraphic and Depositional Controls on Reservoir Quality in Lowstand Incised-Valley Fill and Highstand Shallow-Marine Systems in the Upper Cretaceous (Cenomanian) Tuscaloosa Formation, Louisiana, U.S.A.
- 11:10 Tom Ewing, Frontera:** Insights from the Texas Through Time Project

GROUNDWATER AND ENVIRONMENTAL CASE STUDIES
(Room 332ABC)

Session Chair: Matt Cowan and Ezat Heydari

- 8:30 OPENING REMARKS**
- 8:35 Robert Dedoes, Dynamics Inc.:** Geoscience Based Management of Soil during Oil and Gas Development: A Study Conducted in the Eagle Ford Oil and Gas Development Area
- 9:00 Scott Hamlin, University of Texas at Austin:** Using Electric Logs to Estimate Groundwater Salinity and Map Brackish Groundwater Resources in the Carrizo–Wilcox Aquifer in South Texas
- 9:25 Ezat Heydari, Jackson State University:** Variations in Shallow Groundwater Composition in Hinds and Madison Counties, Mississippi
- 9:50 BREAK**
- 10:20 H. C. Clark, Rice University:** Springfield Spring, Drought Stress, and Aquifer Recovery—A Central Texas Case Study with Implications for Small Town Water Future
- 10:45 Mary Barrett, Consultant:** Historic Oilfield Arsenic Usage and Pit Groundwater Models: An Example from Lake St. John Field, Louisiana
- 11:10 Douglas Carlson, Louisiana State University:** The Environmental Impact of No-Till Farming on Lower Mississippi River Quality

GCAGS SPECIAL BUSINESS FORUM: GEOLOGISTS AS LEADERS IN
FINANCE, BANKING, AND A&D
(Room 332DEF)

Forum Chairs: Steve Brachman and Jeff Lund

- 8:30 to 11:30 Andy Clifford – Saratoga Resources; Dick Stoneburner – Pine Brook Partners; Tom Wilker – Carlyle Group; Jeff Jones – Van Operating and Quantum Energy Partners; and Stuart Burbach – Nautilus Energy**



TUESDAY AFTERNOON, SEPTEMBER 22

—ORAL SESSIONS—

GCAGS EDUCATION/LEADERSHIP FORUM 2.0: Foundational Talks for the Gulf of Mexico II (General Assembly Area A)

Forum Chair: Charles Sternbach

- 1:15 Charles Sternbach:** Opening Remarks
- 1:20 Richard Stoneburner, BHP:** The Discovery, Reservoir Attributes, and Significance of the Hawkville Field and the Eagle Ford Trend: Implications for Future Development
- 2:00 Charles Kerans, University of Texas at Austin:** Cretaceous Carbonate Sequences and Reservoir Systems of the Gulf of Mexico Basin

PANEL DISCUSSION (General Assembly Area A)

Hosts: Charles Sternbach and Scott W. Tinker

- 3:10 to 4:30 Scott W. Tinker, BEG, Tom Tinker, Shell (retired), and Nathan Tinker, University of Texas at Austin:** Geo Generations—60 Years in the 'Patch' and Counting

ONSHORE GULF OF MEXICO EXPLORATION II (General Assembly Area B)

Session Chairs: Tim Rynott and Tom Ewing

- 1:05 OPENING REMARKS**
- 1:10 Larry Baria, Jura-Search:** Relatively Large Mid-Ramp, Highstand, Microbialite Patch and Fringing Reefs: A New Exploration Play for Southern Alabama
- 1:35 Robert Karlewicz, RFH:** The Cotton Valley Limestone Pinnacle Reef Trend, 20 Years Later, East Texas Basin
- 2:00 Charles Goodson, PetroQuest:** *Cris R* in Vermillion Parish, Louisiana: Big Payoff for Conventional Explorers
- 2:25 Tim Rynott, Ridge Resources:** Gulf of Mexico Inboard Lower Tertiary and Cretaceous: Plays and Potential
- 2:50 BREAK**
- 3:20 Martin Cassidy, University of Houston:** The Norphlet Desert and its Sand Dunes: In a Sub-Aerial Environment, but below Sea Level
- 3:45 Jeff Spencer, Amromco Energy:** The 40th Anniversary of South Louisiana's Lower Tuscaloosa Trend—Recollections and Early Media Coverage
- 4:10 Peter Rose, Rose and Associates:** Late Cretaceous and Tertiary Geologic History, Edwards Plateau, Llano Uplift, and Hill Country, Texas

ENVIRONMENTAL AND COASTAL GEOLOGY (Room 332ABC)

Session Chairs: Jeff Paine and Kathleen Haggar

- 1:05 OPENING REMARKS**

- 1:10 Tim Dellapenna, California State University:** Shoreface Sedimentation along a Transgressive Barrier Island: Understanding the Interplay between Short-Term Events and Long-Term Sea Level Rise in Shaping these Dynamic Coastal Environments
- 1:35 Jeff Paine, University of Texas at Austin:** Discriminating Quaternary Depositional Units on the Texas Coastal Plain Using Airborne Lidar and Near-Surface Geophysics
- 2:00 Kathleen Haggar, Dynamic Measurement:** Analysis of the Goose Point Area near Lacombe, Louisiana, Validates New Geophysical Data Type—Natural Sourced Electromagnetism (NSEM)—for Detection of Lineaments Associated with Faults and Sedimentary Features
- 2:25 Bruce Hart, Statoil:** The Greenhorn Cyclothem of the Cretaceous Western Interior Seaway: Lithology Trends, Stacking Patterns, Log Signatures, and Application to the Eagle Ford of West Texas

CHEMOSTRATIGRAPHY AND PALEONTOLOGY
(Room 332ABC)

Session Chair: Clement Bataille

- 3:15 OPENING REMARKS**
- 3:20 Clement Bataille, Chevron:** Chemostratigraphic-Based Age Model for the Black Peaks Formation: Implications for Early Paleogene Paleoclimate in Sub-Tropical North America
- 3:45 Malcolm Hart, UK:** Paleocology of Cretaceous Foraminifera: Examples from the Atlantic Ocean and Gulf of Mexico Region
- 4:10 Ali Somarin, Thermofisher:** Chemostratigraphy and Identification of Fine-Grained Sedimentary Rocks Using Portable XRF
- 4:35 Juan Carlos Silva Tamayo, University of Houston:** Sedimentologic Expression of the Cretaceous Oceanic Anoxic Events along Eastern and Northern Colombia

SEISMIC ATTRIBUTES AND GEOPHYSICAL TECHNOLOGY
(Room 332DEF)

Session Chairs: Sharon Cornelius and Don Van Niewenhuise

- 1:05 OPENING REMARKS**
- 1:10 Andreas Laake, Schlumberger:** Understanding Deepwater Transport Systems through Processing and Interpreting Seismic Data in Color
- 1:35 Deborah Sacrey, Auburn Energy:** Geological Interpretation Using Pattern Recognition from Self-Organizing Maps and Principal Component Analysis
- 2:00 Sharon Cornelius, University of Houston:** Extraction of Seismic Attributes for Reservoir Characterization in Subsalt Environments, Keathley Canyon and Walker Ridge Areas, Gulf of Mexico
- 2:25 Jingqui Huang, University of Houston:** Integrated Fault and Hazard Analysis in Downtown Houston, Texas



NEW IDEAS IN MAPPING AND EXPLORATION
(Room 332DEF)

Session Chairs: Sharon Cornelius and Don Van Niewenhuise

3:15 OPENING REMARKS

3:20 Selim Shaker, GAS: Exploring the Missing Blind Zone in the Gulf of Mexico Shelf

3:45 Paul Comet: The Sulfur to Nitrogen Ratio as an Aid in Mapping the Petroleum Producing Trends of the Contiguous U.S. 48 States Using the USGS Database

4:10 Ibrahim Cemen, University of Alabama: Along Strike Structural Variations in the Frontal Ouachitas-Arkoma Foreland Basin Transition Zone



FUGRO



Providing **integrated oil and gas services** across the **entire life span** of energy developments.

www.fugro.com

Explore the entire Gulf of Mexico.



ION's latest acquisition, MexicoSPAN™, is designed to provide regional coverage of both the prolific exploration and production areas of the western Gulf of Mexico and the exploration frontier margins of the eastern Gulf and northern Yucatán. Combined with ION's YucatánSPAN™, GulfSPAN™ and FloridaSPAN™ programs, MexicoSPAN will deliver the industry's only complete, basin-wide regional view of the Gulf of Mexico. For the first time, explorationists will be able to fully integrate seismic, well and even outcrop information from onshore U.S. to the deepwater Gulf. To learn more, visit iongeo.com/Gulf_of_Mexico

AREAS OF EXPERTISE

- Unconventional Reservoirs
- Challenging Environments
- Complex Geologies
- Basin Exploration
- Reservoir Exploitation



All short courses will be held at the Hilton Americas unless otherwise noted. Check at Registration (Hall B3, GRB CC) prior to the start of a course for availability.
(Sponsored by BHP Billiton)

Short Course #1 — Geosteering for Young Professionals

Saturday, September 19

9:00 am–3:30 pm

Instructor: Sarah Stanley (IHS Energy)

Location: Houston Hilton Americas – Room 335A

Fee: \$150 per person (cost includes refreshments, lunch, and all course materials)

Limit: 25 Total Participants

CANCELED

Short Course #2 — Gulf of Mexico Primer—Regional Overview of the U.S. Deepwater Gulf of Mexico

Saturday, September 19

9:00 am–3:30 pm

Instructors: Gary Steffens, Steve Barker, and Mike DiMarco (Shell Exploration and Production)

Location: Houston Hilton Americas – Room 336AB

Fee: \$150 per person (cost includes refreshments, lunch, and all course materials)

Limit: 70 Total Participants

Short Course #3 — Introduction to Regional and Play-Based Exploration

Saturday, September 19

9:00 am–3:30 pm

Instructor: Frank Love (Ecopetrol – America)

Location: Houston Hilton Americas – Room 337AB

Fee: \$50 per person (cost includes refreshments, lunch, and all course materials)

Limit: 60 Total Participants

Short Course #4 — Core Workshop: Woodbine Sand and Eagle Ford Shale

Saturday, September 19

9:00 am–4:00 pm

Instructors: Bob Loucks and Bill Ambrose (Bureau of Economic Geology)

Location: BEG Houston Research Center • 11611 W. Little York • Houston, TX 77041

Fee: \$195 per person (cost includes transportation from George R. Brown Convention Center to the BEG Houston Research Center, lunch, and all course materials)

Limit: 40 Total Participants

Exama Oil Company

Short Course #5 — AAPG Imperial Barrel Award Competition Training (Students Only)

Sunday, September 20

9:00 am–3:30 pm

Instructors: Larry Garmezy and Steven Bloemendaal (Shell Exploration and Production); with additional past competition participants

Location: Houston Hilton Americas – Room 336AB

Fee: \$50 per person (cost includes refreshments, lunch, and all course materials)

Limit: 70 Total students

Short Course #6 — A User's Guide to Exploration and Production Biostratigraphy

Sunday, September 20

9:00 am–3:30 pm

Instructors: Art Waterman and Ryan Weber (Paleo-Data)

Location: Houston Hilton Americas – Room 335C

Fee: \$150 per person (cost includes refreshments, lunch, and all course materials)

Limit: 50 Total Participants

Short Course #7 — Handheld X-Ray Fluorescence (XRF) Chemostratigraphy: Theory and Application to Mudrock Drill Core and Cuttings

Sunday, September 20

9:00 am–3:30 pm

Instructors: Harry Rowe (Bureau of Economic Geology) and Alexander Seyfarth (Bruker Elemental)

Location: Houston Hilton Americas – Room 337AB

Fee: \$150 per person (cost includes refreshments, lunch, and all course materials)

Limit: 60 Total Participants

Short Course #8 — Introduction to Reservoir Fluid PVT Analysis for Geologists

Sunday, September 20

9:00 am–12:30 pm

Instructor: Toddy Guidry (Core Laboratories)

Location: Houston Hilton Americas – Room 335A

Fee: \$100 per person (cost includes morning refreshments and all course materials)

Limit: 50 Total Participants



bhpbilliton
resourcing the future



*All field trips departure and return at Hilton Americas. Check at Registration (Hall B3, GRB CC) for last-minute availability.
(Sponsored by Weatherford Laboratories)*

Overnight Trips:

Trip #1 — Upper Cambrian Microbial Carbonate Mounds in Central Texas

Thursday, September 17 – Sunday, September 20th

Leaders: André Droxler (Rice University Earth Science), Bill Morgan (Consultant), and Dan Lehrmann (Trinity University Geosciences)

Departure: 3:00 pm

Return: 3:00 pm, Sunday, September 20th

Fee: \$750 per person; \$325 for students (cost includes transportation, guidebook, kayak rental, and hotel; does not include meals or refreshments)

Limit: 20 participants

Trip #2 — Eagle Ford Unconventional Reservoir Field Seminar

Thursday, September 17 – Sunday, September 20th

Leaders: Art Donovan (BP), Mike Pope (Texas A&M University), and Rand Gardner (BP)

Departure: 7:00 am

Return: 2:00 pm

Fee: \$900 per person; \$425 for students (cost includes transportation, guidebook, hotel, and some meals)

Limit: 30 participants

CANCELED

Saturday Trips:

Trip #3 — Geology of Canyon Lake Gorge

Saturday, September 19

Leader: Joel Saylor (University of Houston Earth and Atmospheric Sciences)

Departure: 8:30 am

Return: 6:30 pm

Fee: \$100 per person; \$25 for students (cost includes transportation, lunch and refreshments, guidebook, and admission fee)

Limit: 21 participants

Trip #4 — Spindletop Oil Field—Gladys City Boomtown Museum

Saturday, September 19

Leader: Rosemary Laidacker and Robert Pledger (Ashford Oil & Gas Company)

Departure: 7:30 am

Return: 5:30 pm

Fee: \$125 per person; \$25 for students (cost includes transportation, lunch and refreshments, guidebook, and admission fee)

Limit: 43 participants

CANCELED

Trip #5 — Galveston and the Brazos Delta as Reservoir Analogs

Saturday, September 19

Leader: John Anderson and Jeff Nittrouer (Rice University Earth Science)

Departure: 8:00 am

Return: 5:00 pm

Fee: \$100 per person; \$25 for students (cost includes transportation, lunch and refreshments, and guidebook)

Limit: 21 participants

Sunday Trips:

Trip #6 — Hands-On Geophysical Data Acquisition: Characterizing Shallow Gulf Coast Sediments Using Cuttings, Well Logs, and Seismic Surveys

Sunday, September 20

Leader: Joel Saylor (University of Houston Earth and Atmospheric Sciences)

Departure: 8:00 am

Return: 4:00 pm

Fee: \$250 per person; \$50 for students (cost includes transportation, lunch and refreshments, and guidebook)

Limit: 20 participants

Trip #7 — Field Work on Active Faults in Houston

Sunday, September 20

Leader: Shuhab Khan (University of Houston Earth and Atmospheric Sciences)

Departure: 8:00 am

Return: 4:00 pm

Fee: \$100 per person; \$25 for students (cost includes transportation, lunch and refreshments, and guidebook)

Limit: 18 participants



Weatherford[®]

LABORATORIES

Auburn Exploration



(Student Activities Sponsored by Five States Energy)

STUDENT PARTICIPATION

We offer a special registration fee (only \$35) to facilitate student participation. Students may also register as a Student Volunteer, and if selected as a volunteer and work the required half day as assigned, will receive a refund of their registration fee. This fee allows entry to the Opening Session, Icebreaker, Exhibition, all technical sessions, all coffee breaks, the Presidents' Reception, and receipt of a digital copy of the 2015 GCAGS Transactions.

AAPG IMPERIAL BARREL AWARD COMPETITION TRAINING (Students Only)

Instructors: Larry Garmezy and Steven Bloemendaal (Shell Exploration and Production); with additional past competition participants

Date & Time: Sunday, Sept. 20th • 9:00 am–3:30 pm

Location: Houston Hilton Americas – Room 336AB

Cost: \$50 per person (cost includes refreshments, lunch, and all course materials)

Max. 70 participants (open to students only)

This course is designed to introduce the participant to the fundamentals of basin analysis, the evaluation of petroleum systems, and quantitative prospect assessment (risk and volumes). Following brief lectures, the students will work in teams to evaluate, delineate, and describe the critical elements of a working hydrocarbon province. They will learn about the variety of maps needed to produce an evaluation, how to build play element maps on a specific reservoir interval, summary play maps that describe how the play works, and where sweet spots are located. This is followed by a hands-on suite of exercises that emphasize practical, simple principles for carrying out a quantitative prospect assessment. In addition, this year's course will include insight from past participants who will share their own IBA experiences, and will also assist with the course.

Support your colleagues and network with fellow students and professionals by attending the poster sessions in the exhibit hall (Hall B3) on the third floor of George R. Brown Convention Center. Posters on wide-ranging topics including Deepwater Gulf of Mexico, unconventional plays, portfolio management, sedimentology, and geophysical technology will be available for viewing from Sunday's Icebreaker through Tuesday morning. Poster sessions are an excellent opportunity to expand your knowledge and meet other researchers in your field. Student poster awards will be presented at a special ceremony in the exhibit hall on Monday evening.

Bill Whiting



YOUNG PROFESSIONALS' AND STUDENTS' 'MEET & GREET' (Sponsored by Chevron)

Date & Time: Sunday, Sept. 20 • 3:30 pm–5:00 pm

Location: Grand Ballroom Pre-Function Area

Cost: Free

In addition to all young professionals and students, we strongly encourage all interested professionals to attend this function. This is a great opportunity for the new and upcoming professionals to network with one another and to interact with seasoned industry veterans. Drinks will be available, and following the reception all are encouraged to attend the Opening Session and Awards Ceremony.

18th Annual AAPG/SEG Student Expo

Date: Tuesday and Wednesday, Sept. 22–23

Location: George R. Brown Convention Center

<http://studentexpo.info>

The AAPG/SEG Student Expo is a unique event that links geosciences students with industry recruiters. Students benefit by networking, sharing their resume, presenting their research, and interviewing with multiple employers while companies enjoy cost-efficient and timely recruiting from a diverse and talented student population. Activities at the two-day Student Expo include open poster sessions on geology and geophysics, multiple field trip and short course options, company-sponsored Icebreaker, and a potentially full day of interviews.

Please note that this event is only for current students and recent graduates of Spring or Summer 2015 in geosciences or related fields. The last day to register online (www.studentexpo.info) was 10 September 2015. On-site registration will not be accepted.

Please visit www.studentexpo.info for more information.



FIVE STATES
ENERGY COMPANY, LLC

Roxanna
Oil Company

WHITE MARLIN
Oil and Gas



TEACHER ACTIVITY

GCAGS and the Houston Geological Society recognize the value of helping primary and secondary teachers effectively convey earth science information to their students. We are pleased to present the following course for teachers at minimal cost for participants.

More! Rocks in Your Head – Workshop and Field Experience (Grade 3–12 Teachers Only)

Instructors: Janie Schuelke (consultant), Erik Scott (Talisman Energy), and Angela Scott (teacher)

Date & Time: Saturday, Sept. 19, 8:30 am–3:30 pm

Location: Talisman Energy USA, Inc. • 2445 Technology Forest Blvd., Suite 1200 • The Woodlands, TX 77381; Panther Creek

Cost: \$50 per person (cost includes lunch, all course materials, and take-home items for the classroom)

Max. 45 participants (open to teachers only)

Workshop: This national acclaimed workshop covers a full scope of earth sciences with comprehensive materials enabling full or partial incorporation into curriculum. This workshop empowers educators, regardless of scientific expertise. Topics and hands-on projects covered during the workshop: Earth's Structure; Igneous, Sedimentary, and Metamorphic Rocks; Soil; Caves; Erosion and Deposition; and Minerals.

Field trip: Just south of The Woodlands is the Montgomery County Preserve—a greenway preferred by local residents for its natural beauty. The preserve also holds a natural laboratory to explore a meandering creek system. We will spend part of the day along Panther Creek to investigate its numerous features as well as interact with the processes that form and continually modify them. We will visit a number of locations and discuss the processes that are occurring and the resultant features. Participants will be able to experience the dynamic nature of river systems and expand their understanding of the world in which we live.



HALCÓN
RESOURCES



IN-DEPTH
GEOPHYSICAL

The Guest/Spouse fee includes the Opening Session, Icebreaker, Exhibition, all coffee breaks, Presidents' Reception, "Walk & Talk" lunch, and Hospitality Room on Monday and Tuesday.

HOSPITALITY (Sponsored by Auburn Energy and Exama Oil Company)

Welcome to Houston! We hope you'll join us each day for wonderful conversation, information and your Spouse gift. We have some wonderful enrichment programs lined up that everyone is sure to enjoy in the Hospitality Room. Cost is \$75 and you will receive a name badge for access to the activities.

You'll find our Hospitality Suite located in the Hilton, Room 340AB, conveniently on the other end of the skybridge connected to the George R. Brown Convention Center. Wonderful refreshments will be served morning and afternoon, with wine Monday and Tuesday afternoon at 3:00 pm, courtesy of Deborah Sacrey, Auburn Energy. Our hospitality activities are also underwritten by a generous donation from Jim Grubb, Exama Oil Company.

HOSPITALITY SUITE HOURS Hospitality Room located in the Hilton, Room 340AB

Monday, September 21 8:00 am–4:00 pm
Tuesday, September 22 8:00 am–4:00 pm

GCAGS HOSPITALITY ENRICHMENT PROGRAMS

Feng Shui

Meet Trisha Keel, Ph.D., Teacher, Professional Feng Shui Practitioner and Trainer, Graphic Designer

Date & Time: Monday, September 21, 10:00 am–11:00 am

Location: Hilton Americas Hotel, Room 340AB

Fee: \$0 (cost included in guest fee)

Join us Monday, September 21, 2015, at 10:00 am when Dr. Trisha Keel will teach how to balance everything in our lives using Feng Shui. Come and enjoy her special presentation.

Seven Significant Signs of the Serious Liar?

Meet Alice Weiser

Date & Time: Monday, September 21, 1:00 pm–2:00 pm

Location: Hilton Americas Hotel, Room 340AB

Fee: \$0 (cost included in guest fee)

Want to know the Seven Significant Signs of the Serious Liar? Alice Weiser, handwriting and body language expert, will tell us. Join us for a fun hour of enlightenment on Monday, September 21, 2015, at 1:00 pm.

Houston's Underground

Date & Time: Tuesday, September 22, leaving at 10:00 am

Fee: \$25 (not included in guest fee)

Space still available! (check at the Spouse Hospitality Room)

On Tuesday, September 22, 2015, at 10:00 am, become familiar with Houston's Underground when we take a guided walking tour of the Tunnel System under downtown Houston, make a lunch stop along the way, and learn about some of Houston's most historical buildings.



GCAGS 2015

GCAGS Officers

President.....	Charles Sternbach
Vice President.....	Brent Hopkins
Treasurer	Steve Hill
Past President	Mary Broussard
Executive Director.....	Kate Kipper

Convention Organizing Committees

Convention General Chair.....	Larry D. Bartell
Convention Treasurer	Mike Erpenbeck
Convention Secretary and Social Media.....	Dianna Phu
Technical Program Chair	Linda Sternbach
Non-Technical Chair.....	Deborah Sacrey
Poster Chair	Meredith Faber
GCSSEPM President.....	Thomas Hearon
GCSSEPM President-Elect.....	Dorene West
GCSSEPM Vice President.....	Sophie Warny
GCSSEPM Secretary.....	Charlotte Jolley
GCSSEPM Treasurer.....	Brandi Pool Sellepack
GCSSEPM Past-President.....	J. Carl Fiduk
AAPG Student Expo Mentor	Martha Lou Broussard
AAPG/SEG Student Expo	Fernando E. Ziegler
GCAGS Managing Editor and Publisher.....	James Willis
GCAGS <i>Journal</i> Editor	Barry Katz
GCAGS <i>Transactions</i> Editor	Steve Levine
GCSSEPM <i>Transactions</i> Editor	Patricia Ann Santogrossi
Judging.....	Sandy Rushworth and David L. Risch
Short Courses	Hunter Lockhart
Field Trips	Julia S. Wellner and Robert W. Wellner
Luncheon/Speaker	Charles Sternbach
Sponsorship	Jeff Lund
Exhibits.....	Bill Mason
Volunteers.....	James M. Grubb
Printing	David M. Orchard
Webmaster.....	Dianna Phu
Spouse/Guest Activities	Sally Blackhall
Entertainment.....	Richard Ball





THUNDER EXPLORATION, INC.



First Rock





REPSOL

SEI[®] SEISMIC EXCHANGE



George R. Brown Convention Center
(Convention Headquarters)
1001 Avenida de las Americas, Houston, TX 77010

Parking Map

Parking Map



AAPG

Young Professionals



George R. Brown Convention Center Floor Plan of Level 3

Floor Plan



The Exhibit Hall (GRB CC Hall B3) will be the host area for a number of events, so there will be plenty of opportunities to explore all that the exhibitors have to offer, see old acquaintances, and forge new ones.

- The traditional Icebreaker cocktail party held on Sunday in the hall;
- The Presidents' Reception will be held in the Exhibit Hall from 4:30 pm to 6:00 pm on Monday, and will include the Student Best Paper Awards Ceremony and the Oldest GCAGS bag contest;
- Extended breaks in the morning and afternoon oral sessions will permit in-depth discussions with the poster presenters; and

Exhibition Hours

Sunday, 20 September (Icebreaker) 6:00 pm–8:00 pm
Monday, 21 September 8:30 am–6:00 pm
Tuesday, 22 September 8:30 am–1:30 pm

- A free 'walk & talk' box lunch on Tuesday.

Please note that children under the age of 13 will not be allowed in the exhibit hall anytime during exhibit setup or teardown.

During exhibit hours, children not of school-age will not be allowed into any activities within the exhibit hall, including the Icebreaker reception, unless they are young enough or small enough to be confined to a stroller, backpack, or front pack.

School-age children will be allowed to attend the exhibition during regularly scheduled hours if they are properly registered (as students) and they wear their badges at all times.



George R. Brown Convention Center
Exhibit Hall B3 Floor Plan

Exhibit Hall Map

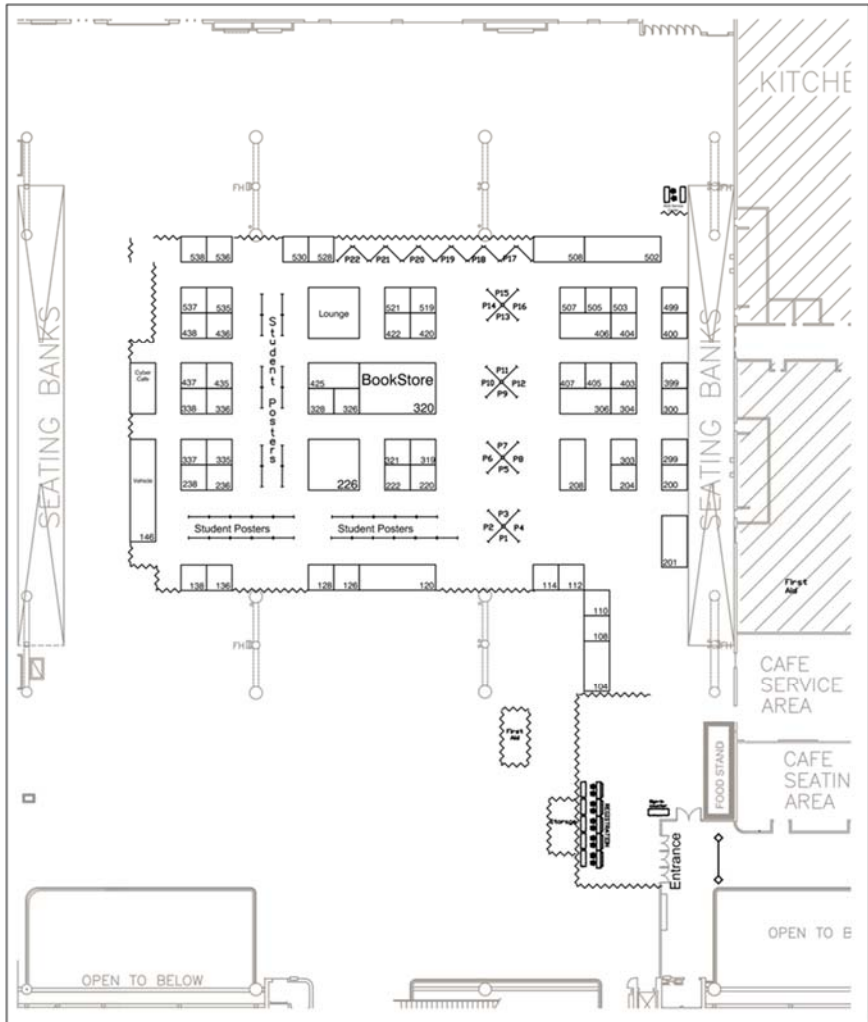

Exhibitor	Booth No.	Product/Service Description
2016 GCAGS Annual Convention September 18–20, ABC Center Corpus Christi, Texas Dawn Bissell, General Chair bissells@swbell.net 361–960–2151 www.gcags2016.com <i>Technical Talks, Short Courses, Field Trips & More!</i> <i>Hosted by the Corpus Christi Geological Society</i>	321	We're planning a BIG Event in our SPARKLING CITY at the American Bank Center. Accommodations at the Omni Hotel, along the bayfront is walking distance to the convention and local attractions. Start planning today to participate or attend the GCAGS in Corpus Christi in September 2016. We look forward to seeing old friends and new faces!
AAPG www.aapg.org	436	Providing publications, conferences, and education.
Advanced Geosciences, Inc. Jason Greenwood sales@agiusa.com 512–335–3338 www.agiusa.com <i>Real time color pseudo-section presentation</i>	300	AGI is the manufacturer of the <i>SuperSting</i> geo-electrical tomography system. Remote control and real time data quality analysis is achieved using an Android device. Some applications of the <i>SuperSting</i> system are deep mineral exploration, subsurface pollution mapping, shallow and deep marine hydrocarbon exploration, agriculture, geotechnical and geological investigation.
AGT www.agtgeo.com	405	
ALS Oil and Gas www.alsoilandgas.com	226	
BRUKER Tom Leone 847–370–6744 www.bruker.com/hhxf	328	Bruker is known worldwide as a leader in all forms of X-ray analysis equipment ranging from handheld XRF analyzers to large XRF and XRD analyzers. Handheld XRF mining analyzers provide fast on-site analysis to supplement laboratory testing. In addition, handheld XRF can be used in your geological research.
Bureau of Economic Geology www.beg.utexas.edu	404	Bureau researchers spearhead basic and applied research projects around the world; among them, research in energy resources and economics, coastal and environmental studies, land resources and use, geologic and mineral mapping, hydrogeology, geochemistry, and subsurface nanotechnology.
Bureau of Ocean Energy Management www.boem.gov	507	The Bureau of Ocean Energy Management (BOEM) promotes energy independence, environmental protection and economic development through responsible, science-based management of offshore conventional and renewable energy resources.



CGG cgg.com	122– 124– 126	CGG is a fully integrated Geoscience company providing leading geological, geophysical and reservoir capabilities to its broad base of customers primarily from the global oil and gas industry.
Chemostrat, Inc. www.chemostrat.com	306– 308	
Core Mineralogy, Inc. www.coremineral.com	114	
DownUnder GeoSolutions Richard Weindel richardw@dugeo.com +61 (08) 9287 4100 www.dugeo.com <i>S.Processing, Depth Imaging, QI, Petro, Software</i>	407	DownUnder GeoSolutions is an innovative, global geosciences company with a diverse range of capabilities and an integrated service offering: Illumination studies–Seismic processing–Depth imaging–Petrophysics–Quantitative interpretation–Depth conversion–Multi-client studies–DUG software. Please visit www.dugeo.com .
Dynamic Graphics	238	Dynamic Graphics, Inc. (DGI) delivers innovative software solutions to the petroleum industry, developing products uniquely positioned to fill decision gaps related to geoscience interpretation, drilling optimization and reservoir surveillance. With CoViz 4D software, DGI is again pioneering a new solution category, "Dynamic Visual Analytics," combining data integration and 3D visualization features with powerful temporal data analytics to speed understanding and improve decisions from exploration through field maturity. Other pioneering products include WellArchitect, for advanced 3D well planning, directional drilling, and survey management, and EarthVision, a superior 3D earth modeling application to accurately resolve highly complex geologic structures.
Dynamic Measurement	435	
Earthy Goods/Pierret Jewelers	503	Pierret Designs specializes in the custom design and creation of opal, metallic and jewelry set with a variety of semi-precious and precious stones. It has over 40 years of experience and is located in "Jewelry Capitol" (University Building) in the heart of downtown Denver and is a completely equipped modern facility. Creation of Australian black opal jewelry is a specialty. Earthy Goods specializes in selling fine specimens of Fluorites from southern Illinois, and other unique mineral specimens from around the world. Its owner is Richard Inden, an oil and gas geologist.

<p>East Texas Geological Society Kathy Moore info@pdilyertexas.com 903-597-8881 www.easttexasgeo.com <i>Browse online database of energy data & log images</i></p>	<p>138</p>	<p>The East Texas Geological Society was founded in 1931. Based in Tyler, Texas, the society hosts a monthly meeting for members, a yearly tech & prospect expo, and other events. Dues are \$25 annually, from July through June of the following year. The society also supports Petroleum Data Library, a nonprofit organization with facilities in Tyler.</p>
<p>Enthought Courtenay Godshall cgodshall@enthought.com 512-731-3990</p>	<p>126–128</p>	
<p>FairfieldNodal www.fairfieldnodal.com</p>	<p>406–408</p>	<p>FairfieldNodal, the leader in seismic nodal technology, offers a full spectrum of revolutionary acquisition systems and technology services. The company, known for its extensive spec-data library, also provides acquisition, imaging, processing, and licensing.</p>
<p>GCAGS Bookstore www.gcags.org</p>	<p>320</p>	<p>If you purchased a hard copy of the <i>2015 GCAGS Transactions</i> or the <i>Journal</i>, please present your redemption voucher to pick up your book. Stay and browse as long as you like!</p>
<p>GCSSEPM Foundation www.gcssepm.org</p>	<p>326</p>	<p>The GCSSEPM comprises two autonomous associated organizations: the Gulf Coast Section SEPM (GCSSEPM), est. in 1953, and the GCSSEPM Foundation, est. in 1981. Their mission is to promote the science of stratigraphy in the Gulf Coast states through research in paleontology and sedimentary petrology, especially as it relates to petroleum geology.</p>
<p>Gems & Crystals Unlimited www.gemsandcrystalsunlimited.com <i>Customized gold and platinum jewelry</i></p>	<p>208</p>	<p>Complete custom work, including engagement, anniversary and any special celebrations for you! Outstanding collection of gemstones, diamonds, rubies, sapphires, emeralds, tanzanite, etc. Great collection of Art Deco and other antique jewelry in gold, platinum, and silver, cameos, cufflinks, pins and collectibles. Crystals and minerals too!</p>
<p>GeoCare Benefits Insurance www.geocarebenefits.com <i>All your Insurance needs!</i></p>	<p>438</p>	<p>AAPG encourages members to participate in our GeoCare Group Insurance. Plans include Medical (through AAPG's GeoCare Members' Private Medical Insurance Exchange), Term Life, Cancer Expense, Dental, Disability, Medicare Supplement and other supplemental plans. The Program sponsors Auto, Homeowner and other Personal Lines of coverage.</p>



GeoFrontiers www.geofrontiers.com	420	GeoFrontiers acquires trace gas and liquid hydrocarbon data for geochemical exploration. We solve difficult problems in severe environments, interpret, and integrate with seismic data. Recent capability additions include soil gas probe.
Geomap Company Trey Morgan tmorgan@geomap.com 972-578-0571 www.geomap.com	336	Geomap Company provides customers with objective interpretations that save time and money when investigating new areas. Our Geologic Mapping Service gives subsurface interpretations and includes Library Membership, which allows customers to access well logs, scout tickets, production data and reference material at all Library locations.
GeoMark Research, LTD. www.geomarkresearch.com <i>Analytical Services, Databases & Regional Studies</i>	236	GeoMark Research, a geochemical laboratory, offers a full range of source rock, oil, and gas services. Through a combination of analytical services, regional studies, and integrated database products, GeoMark provides a full complement of exploration and production services—the only lab to offer this combination of services, studies and databases.
Geophysical Insights www.geoinsights.com <i>Paradise™ – Multi-Attribute Analysis Platform</i>	425–427	Geophysical Insights provides the Paradise™ multi-attribute analysis platform that uses advanced pattern recognition to extract more information and increase definition and from the seismic response. Visit Paradise to see how exploration risk and field development cost are being dramatically reduced.
GETECH Andrea Miscia andrea.miscia@getech.com 713-979-9900 www.getech.com	335	Getech offers the most comprehensive and detailed gravity database for On-shore US. Together with our magnetic holdings and extensive interpretation services, we offer cost effective exploration solutions across all Lower 48 US basins and plays. Visit Getech at booth #335 to learn how we can help your exploration initiatives.
Gravity Map Service/ Thompson Solutions, LLC www.thompsonsolutions.com gravityservices.com	519	High Resolution Non-Exclusive Gravity & Magnetic Data. Custom Processing, Interpretation & Consulting Services.
Horizon Well Logging, LLC www.hzmud.com <i>Mud Logging, GeoSteering, Geochemical</i>	319	Horizon Well Logging is the premier mud logging and geosteering firm supporting natural gas and oil exploration companies from the Mid-continent, S. Texas, Rockies, Appalachia region and beyond since 1988 utilizing cutting edge technology.

<p>Horizontal Solutions International George Gunn ggunn@horizontalsi.com 972-416-1626 www.horizontalsi.com <i>Geosteering Software and Consulting</i></p>	304	<p>HSI provides premier geosteering software and horizontal drilling consulting services proven to increase oil and gas production from horizontal drilling programs. Our staff of seasoned professionals track stratigraphic position and steer to maximum pay, even in the most complex structural and stratigraphic settings.</p>
<p>Houston Geological Society www.HGS.org</p>	136	
<p>iBall Instruments www.iballinst.com</p>	110	
<p>Integrated Geophysics Corporation www.igcworld.com</p>	204	<p>Potential fields, integrated geological and geophysical interpretation services; identifying goals, acquisition, interpretation and integration of a wide range of geological and geophysical data.</p>
<p>Interactive Exploration Solutions (INEXS) www.inexs.com <i>2 Prospects: E. TX Woodbine & LA Tuscaloosa Sand</i></p>	530	<p>Interactive Exploration Solutions Inc. (INEXSA[®]) is a relationship-driven geological, geophysical and petroleum engineering consulting company offering fully integrated regional and field studies and evaluations of undeveloped reserves. INEXS specializes in bringing clarity to our clients using patterns, nuances, complexities and accumulations.</p>
<p>ION www.iongeo.com</p>	201–203	<p>ION is a leading provider of technology-driven solutions to the global oil & gas industry. ION's offerings are designed to help companies reduce risk and optimize assets throughout the E&P lifecycle. For more information, visit iongeo.com.</p>
<p>Lafayette Geological Society www.lafayettegeologicalsociety.org</p>	537	
<p>LMK Resources Mark Mixon mmixon@lmkr.com 281-495-5657 www.lmkr.com <i>LMKR is the global provider of GeoGraphix[®].</i></p>	521	<p>LMKR is a petroleum technology company with an extensive solutions portfolio; LMKR is also the global provider of GeoGraphix[®], a complete, affordable, geoscience system offering leading edge mapping; geological, geophysical & petrophysical modeling; well and field planning; and state-of-the-art 3D visualization.</p>
<p>Lynx Information Systems www.lynx-info.com</p>	303	<p>Lynx are the industry leaders in Seismic Vectorizing (paper to SEG-Y & SEG-P1), GIS and digital mapping. We can handle any hardcopy/scanned data that requires digitizing, including any seismic, base maps, contour maps, and well logs.</p>
<p>MICRO-STRAT, Inc. www.micro-strat.com</p>	535	
<p>MUD Geochemical, Inc. Mudgeochemical.com</p>	499	



Neuralog www.neuralog.com <i>Desktop – Well Data, Document & Log Management</i>	220	Neuralog provides solutions for well, log and document management, log data capture including mud log lithology, volumetric and reserves calculations, geological analysis, well log printing and scanning. Desktop is a powerful Esri-based interface for organizing your company's well data, logs, and documents into meaningful global views.
Paladin Geological Services www.PaladinGeo.com	400	
Paleo-Data, Inc. www.paleodata.com <i>Domestic & International Biostratigraphic Services</i>	422	
PetroStrat, Inc. www.petrostrat.com	299	
PML Exploration Services LLC Daniel Baker dbaker@edgelog.com 281-376-4452 www.pmls.com <i>Mudlogging, Quality personnel, Rental Gas Systems</i>	104–106	PML provides, Mud logging, Geosteering, Remote logging & Gas detection services to energy companies. Additionally, our subsidiary, EDGE Systems provides rental gas analyzers to other service providers. Our lead loggers have at least 5 years experience and/or a degree in geology. Our systems are web enabled to provide logs, calibration, etc.
Rock Solid Images (RSI) www.rocksolidimages.com	108	RSI is an independent geoscience consulting firm offering quantitative reservoir characterization services to reduce exploration risk and optimize appraisal and development plans.
Schlumberger	146	
Seismic Exchange, Inc. www.seismicexchange.com	222	SEI® is a full service 2D and 3D seismic data marketing firm established in 1975, with offices located in Dallas, Houston, Denver, New Orleans, Corpus Christi and Tulsa. SEI owns over 1,850,000 miles of domestic proprietary 2D seismic data and has over 54,000 square miles of domestic proprietary 3D seismic data located on-shore across the US.
Selman & Associates Tom Selman tselman@selmanlog.com 432-288-2259 www.selmanlog.com	338	Come Visit Selman! With 32 Years of proven well-site experience, we are your choice for surface and/or mud logging, geochemistry and communication services from the Gulf Coast to the Rocky Mountains.

<p>SEPM (Society for Sedimentary Geology) Hayley Cooney hcooney@sepm.org 918-610-3361, ext. 100 www.sepm.org</p>	<p>399</p>	<p>SEPM is dedicated to the dissemination of scientific information on sedimentology, stratigraphy, paleontology, marine geology, hydrogeology, and many related specialties. The Society publishes two major scientific journals, <i>Journal of Sedimentary Research</i> and <i>PALAIOS</i>, and produces technical conferences, short courses, and Special Publications.</p>
<p>SMART4D Geosteering www.smart4d.com</p>	<p>403</p>	
<p>Task Fronterra Geoscience www.taskfronterra.com</p>	<p>112</p>	
<p>TGS Wayne Millice wayne.millice@tgs.com www.tgs.com</p>	<p>200</p>	<p>TGS provides multi-client data including seismic data & digital well logs to oil & gas companies worldwide. TGS offers advanced processing & imaging services, interpretation products & data integration solutions.</p>
<p>The Leeds Group www.leedsgrp.com <i>Geochemistry, Basin Modeling, and Petrophysics</i></p>	<p>528</p>	<p>The Leeds Group provides rock-based solutions for petroleum exploration and production operations. We represent an international network of the industry's proven, top service providers for each of the service niches your project requires.</p>
<p>Thompson Solutions, LLC/ Gravity Map Service www.thompsonsolutions.com gravityservices.com</p>	<p>519</p>	<p>High Resolution Non-Exclusive Gravity & Magnetic Data. Custom Processing, Interpretation & Consulting Services.</p>
<p>Weatherford www.weatherford.com</p>	<p>502–504, 506–508–510</p>	<p>Weatherford is among the largest global oil and gas service providers, operating in more than 100 countries and delivering innovative technologies and services for drilling, formation evaluation, well construction, completion, stimulation, and production.</p>



